



---

Northwestern Water and Sewer District  
2024 Portage Water Main Replacement  
WL-306E

---

**ADDENDUM 1**

---

8/8/24

Planholders of the Northwestern Water and Sewer District, 2024 Portage Water Main Replacement, SS-306E, project are hereby notified of the following amendments to the Contract Documents. This Addendum is hereby made a part of the Contract Documents.

**DRAWINGS**

Replace Sheet G-0.3 with the attached sheet that shows the updated items and quantities.

Replace Sheet W-1.1 with the attached sheet that shows the updated connection at Water Street.

Replace Sheet W-2.1 with the attached sheet that shows the updated connection at Water Street.

Replace Sheet SR-1.1-2 with the attached sheet that shows the updated surface repair for the connection at Water Street.

Replace Sheet SR-0.1 with the attached sheet that shows the updated trench repair details.

**SPECIFICATIONS**

***Pages C-410-6 – C-410-7***

Remove the bid form in its entirety and replace with the attached bid form.

An excel version of the bid form is available at <https://tinyurl.com/5b6dujt4> .

**QUESTIONS**

The following questions were submitted to the Engineer. The answers provided below are for the clarification of Bidders questions. Questions have been paraphrased for brevity.

***Question #1 – Are there bore logs available?***

Yes, see Specification C-800-2 – C-800-3 for links to soil boring reports.

Attachments:

Updated Drawing Sheets

Bid Form

**RECEIPT OF THIS ADDENDUM MUST BE ACKNOWLEDGED ON PAGE C-410 - 1 OF THE BID.**

Item No.	Plan Quantity	Contingency Quantity	Grand Total	Unit	Description	W-1.1	W-1.2	W-1.3	W-1.4	W-1.5	W-2.1	W-3.1	W-4.1	W-5.1
1	1	0	1	LS	Mobilization and Demobilization	0	0	0	0	0	0	0	0	0
2a	58	8	66	LF	6-inch Water Main, Type B	0	0	0	0	0	5	0	0	53
2b	0	13	13	LF	6-inch Water Main, Type C	0	0	0	0	0	0	0	0	0
2c	266	17	283	LF	8-inch Water Main, Type B	0	0	0	0	0	80	94	92	0
2d	0	10	10	LF	8-inch Water Main, Type C	0	0	0	0	0	0	0	0	0
2e	4	6	10	LF	10-inch Water Main, Type B	0	0	0	0	0	0	0	4	0
2f	6	4	10	LF	10-inch Water Main, Type C	3	0	0	0	3	0	0	0	0
2g	2524	16	2540	LF	12-inch Water Main, Type B	397	550	550	550	370	0	0	107	0
2h	62	8	70	LF	12-inch Water Main, Type C	55	0	0	0	7	0	0	0	0
2i	10	0	10	EA	Connection to Existing Water Mains 12-inch and Smaller (Without Tapping)	1	0	0	0	1	1	2	4	1
2j	16	0	16	EA	Existing Water Main Plugged	0	2	6	0	2	2	4	0	0
2k	5	0	5	EA	Water Main Termination and Abandonment	1	0	0	0	1	1	0	0	2
3a	1	0	1	EA	6-inch Gate Valve and Box	0	0	0	0	0	0	0	0	1
3b	5	0	5	EA	8-inch Gate Valve and Box	0	0	0	0	0	1	2	2	0
3c	3	0	3	EA	12-inch Gate Valve and Box	1	0	0	0	0	0	0	2	0
3d	5	0	5	EA	12-inch Gate Valve and Manhole	1	1	2	1	0	0	0	0	0
3e	8	0	8	EA	Valve Box Abandoned	1	2	1	1	0	1	1	0	1
3f	2	0	2	EA	Valve Box Removed	0	0	0	0	0	0	0	2	0
4a	4	0	4	EA	Fire Hydrant Assembly, Type A	0	0	1	1	1	1	0	0	0
4b	1	0	1	EA	Fire Hydrant Assembly, Type B	1	0	0	0	0	0	0	0	0
4c	5	0	5	EA	Fire Hydrant Assembly Removed	1	0	1	1	1	1	0	0	0
5a	612	20	632	LF	Trenchless Water Service (Less than 2-inch diameter)	76	76	191	154	115	0	0	0	0
5b	367	0	367	LF	Water Service (Less than 2-inch diameter)	92	115	138	22	0	0	0	0	0
5c	39	0	39	EA	Water Service Connection Reinstated (Less than 2-inch diameter)	6	9	12	7	5	0	0	0	0
5d	5	0	5	EA	Tandem Water Meter Pits (Without Meter)	0	2	1	2	0	0	0	0	0
5e	27	0	27	EA	Water Meter Pits (Without Meter)	6	5	10	3	3	0	0	0	0
6a	9	22	31	SY	Flexible Pavement Trench Repair - Residential Roadway	0	0	0	9	0	0	0	0	0
6b	2091	23	2114	SY	Flexible Pavement Trench Repair - Heavy Roadway	366	475	591	412	247	0	0	0	0
6c	2100	23	2123	SY	Temporary Pavement Repair	366	475	591	421	247	0	0	0	0
7a	6	24	30	SY	6-inch ODOT Item 452 Non-Reinforced Concrete Pavement, Class MS (Residential Drive Approach)	0	0	0	6	0	0	0	0	0
7b	1059	25	1084	SF	4-inch Concrete Sidewalk	128	230	366	194	141	0	0	0	0
7c	486	26	512	SF	6-inch Concrete Sidewalk and Curb Ramp with Detectable Warning Surface	0	150	297	0	39	0	0	0	0
8	189	18	207	LF	Concrete Curb	0	42	72	45	30	0	0	0	0
9a	10	20	30	LF	Sewer Repair (Less than or equal to 10-inch diameter)	0	10	0	0	0	0	0	0	0
9b	40	20	60	LF	Sewer Repair (12-inch diameter to 18-inch diameter)	5	0	0	0	0	0	10	25	0
10	1	0	1	LS	Video Recording of the Zone of Influence	0	0	0	0	0	0	0	0	0
11	1	0	1	LS	Maintenance of Traffic	0	0	0	0	0	0	0	0	0
12	1	0	1	LS	Storm Water Pollution Prevention	0	0	0	0	0	0	0	0	0
13	1	0	1	LS	Clearing and Grubbing	0	0	0	0	0	0	0	0	0
14	0	1100	1100	LF	Rock Excavation	0	0	0	0	0	0	0	0	0
Allowance	1	0	1	LS	Utility Pole Holding	0	0	0	0	0	0	0	0	0

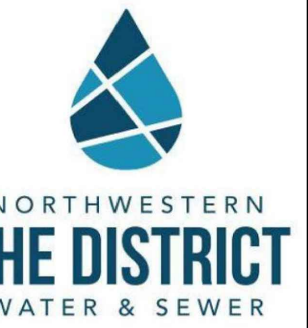

**GENERAL SUMMARY**  
NORTHWESTERN WATER & SEWER DISTRICT  
2024 PORTAGE WATER MAIN REPLACEMENT

NO. 1  
2  
3  
4  
5  
6  
7  
8  
9  
10  
11  
12  
13  
14  
15  
16  
17  
18  
19  
20  
21  
22  
23  
24  
25  
26  
27  
28  
29  
30  
31  
32  
33  
34  
35  
36  
37  
38  
39  
40  
41  
42  
43  
44  
45  
46  
47  
48  
49  
50  
51  
52  
53  
54  
55  
56  
57  
58  
59  
60  
61  
62  
63  
64  
65  
66  
67  
68  
69  
70  
71  
72  
73  
74  
75  
76  
77  
78  
79  
80  
81  
82  
83  
84  
85  
86  
87  
88  
89  
90  
91  
92  
93  
94  
95  
96  
97  
98  
99  
100

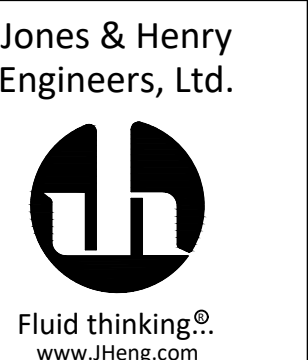

Jones & Henry Engineers, Ltd.  
Fluid thinking®  
www.JHeng.com

JOB NO. 796-8122.001  
SCALE AS INDICATED  
THIS LINE SCALES IF WHEN PLOTTED TO NOTED SCALE  
DESIGNED EAF DRAWN DJK CHECKED TAB  
STATUS ISSUED FOR BID  
DATE MAY 2024  
SHEET NO. G-0.3  
3 OF 25



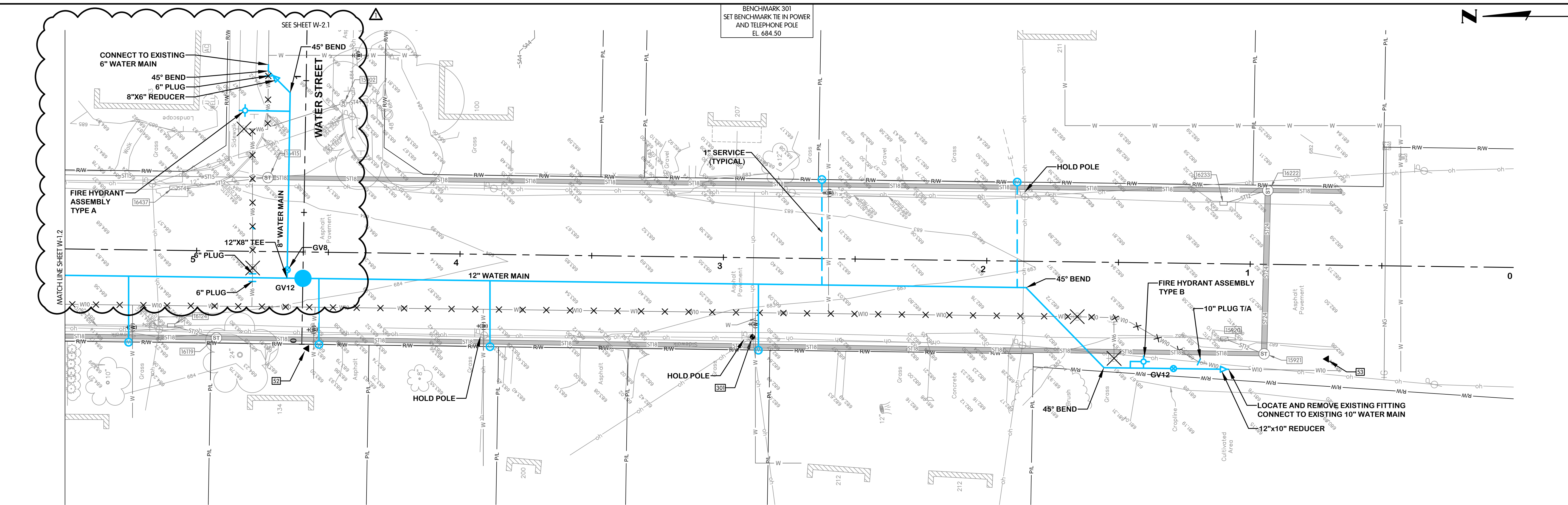

**SOUTH FINDLAY PIKE**

EXISTING STRUCTURE DATA			EXISTING STRUCTURE DATA			EXISTING STRUCTURE DATA		
NAME	TYPE	DATA	NAME	TYPE	DATA	NAME	TYPE	DATA
15902	CATCH BASIN	CASTING EL. 684.21 4" S INV. EL. 681.31 6" N INV. EL. 681.21	16119	STORM MANHOLE	CASTING EL. 684.14 18" N INV. EL. 676.64 12" N INV. EL. 678.14 18" S INV. EL. 676.64	16233	CATCH BASIN	CASTING EL. 682.06 12" S INV. EL. 675.56
15920	CATCH BASIN	CASTING EL. 681.78 12" S INV. EL. 677.58	16124	CATCH BASIN	CASTING EL. 683.72 12" S INV. EL. 679.62	16415	STORM MANHOLE	CASTING EL. 684.00 15" N INV. EL. 676.80 12" N INV. EL. 680.00 18" S INV. EL. 676.80
15921	STORM MANHOLE	CASTING EL. 682.00 18" N INV. EL. 675.85 12" N INV. EL. 677.10 24" E INV. EL. 675.70	16222	STORM MANHOLE	CASTING EL. 682.28 24" W INV. EL. 675.78 18" N INV. EL. 675.78 12" N INV. EL. 677.08 18" S INV. EL. 675.38	16437	CATCH BASIN	CASTING EL. 683.95 4" S INV. EL. 680.45 12" S INV. EL. 680.45

- NOTES:
- THE CONTRACTOR SHALL VERIFY THE LOCATION OF TAPS AND WATER SERVICES.
  - CONTRACTOR SHALL PROVIDE WATER SERVICE CONNECTIONS OF A DIAMETER TO MATCH THE ORIGINAL NOMINAL DIAMETER OF THE SERVICE. THE MINIMUM WATER SERVICE DIAMETER SHALL BE 1". WATER SERVICE WITH NO SIZE SHOWN SHALL BE ASSUMED TO BE 1" DIAMETER.
  - WATER SERVICES ARE SHOWN OFFSET FROM THE EXISTING WATER SERVICES FOR CLARITY AND SHALL BE INSTALLED ALONG THE SAME ALIGNMENT.
  - THE DISTRICT WILL SHUT DOWN THE EXISTING WATER MAIN FOR A PERIOD OF 4 HOURS TO PERMIT THE CONTRACTOR TO REMOVE SUFFICIENT LENGTH OF WATER MAIN AND CONNECT THE PROPOSED NEW WATER MAIN TO THE EXISTING WATER MAIN.
  - WHEN REMOVING ASBESTOS CEMENT PIPE, THE CONTRACTOR SHALL TAKE ALL MEASUREMENTS NECESSARY TO COMPLY WITH REQUIREMENTS SET BY NESHAP AND OSHA.
  - DEPTH OF WATER MAIN PLANNED TO ACCOMMODATE FUTURE ODOT ROADWAY IMPROVEMENTS.

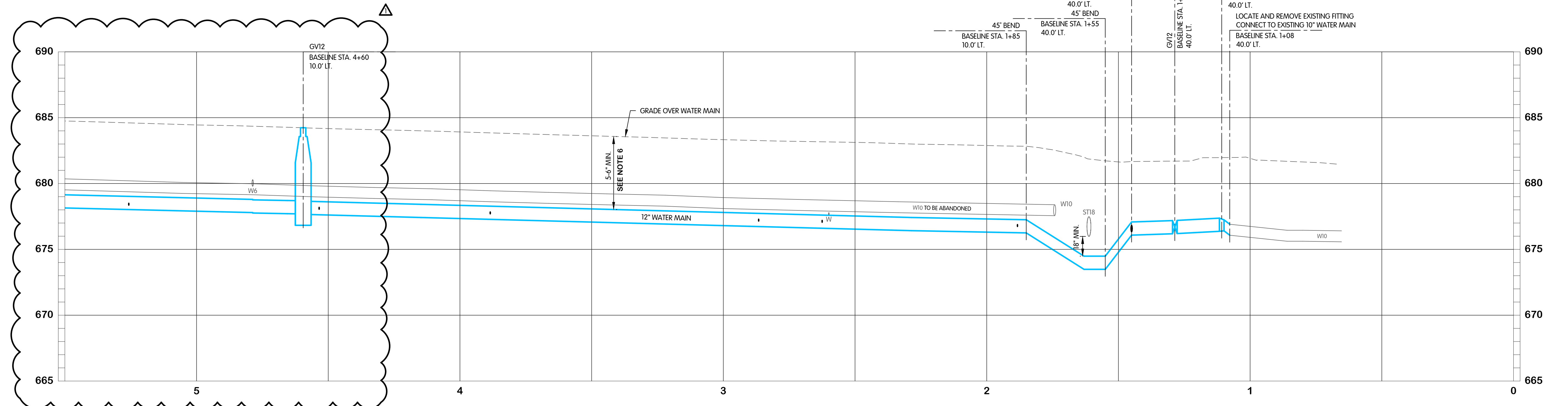

TOL-8122001-W-H-S FINDLAY STA. 0+00 TO 5+50  
8/8/2024, 12:31 PM - DOLLAR  
8/8/2024, 12:39 PM

DESIGNED EAF  
DRAWN DJK  
CHECKED TAB

STATUS: ISSUED FOR BID  
DATE: MAY 2024

NO. 1  
DATE 8/8/2024  
ADDENDUM 1

REVISIONS AFTER ISSUED FOR BID

Jones & Henry  
Engineers, Ltd.

Fluid thinking®  
www.JHeng.com

JOB NO. 796-8122.001  
SCALE 1"=20' HOR.  
1"=4' VERT.  
THIS LINE SCALES IF WHEN PLOTTED TO NOTED SCALE

SHEET NO. W-1.1  
4 OF 25



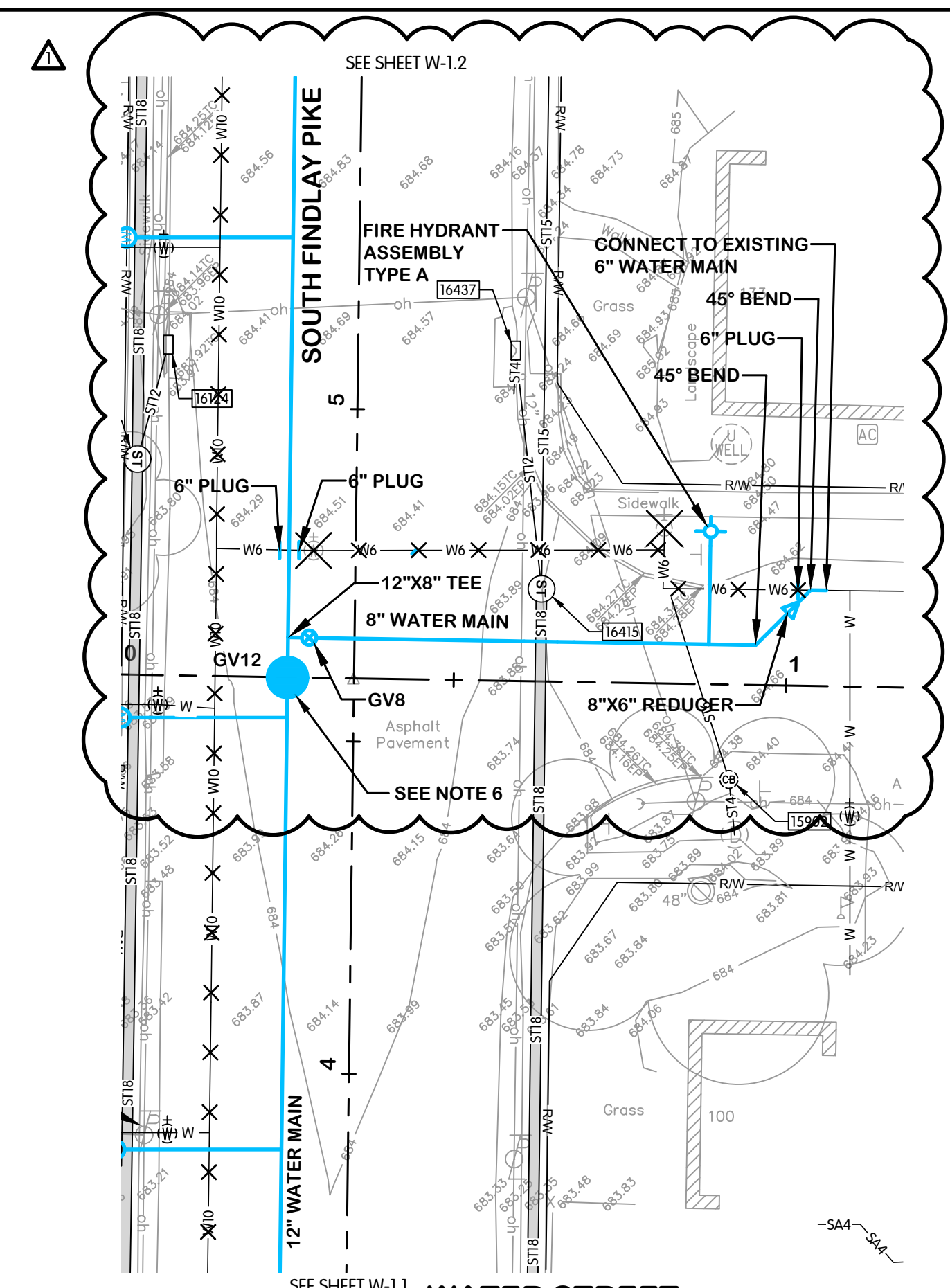

EXISTING STRUCTURE DATA			EXISTING STRUCTURE DATA		
NAME	TYPE	DATA	NAME	TYPE	DATA
15902	CATCH BASIN	CASTING EL. 684.21 4" S INV. EL. 681.31 6" N INV. EL. 681.21	16415	STORM MANHOLE	CASTING EL. 684.00 15" N INV. EL. 676.80 12" N INV. EL. 680.00 18" S INV. EL. 676.80
16119	STORM MANHOLE	CASTING EL. 684.14 18" N INV. EL. 676.64 12" N INV. EL. 678.14 18" S INV. EL. 676.64	16437	CATCH BASIN	CASTING EL. 683.95 4" S INV. EL. 680.45 12" S INV. EL. 680.45
16124	CATCH BASIN	CASTING EL. 683.72 12" S INV. EL. 679.62			

- NOTES:**
- THE CONTRACTOR SHALL VERIFY THE LOCATION OF TAPS AND WATER SERVICES.
  - CONTRACTOR SHALL PROVIDE WATER SERVICE CONNECTIONS OF A DIAMETER TO MATCH THE ORIGINAL NOMINAL DIAMETER OF THE SERVICE. THE MINIMUM WATER SERVICE DIAMETER SHALL BE 1". WATER SERVICE WITH NO SIZE SHOWN SHALL BE ASSUMED TO BE 1" DIAMETER.
  - WATER SERVICES ARE SHOWN OFFSET FROM THE EXISTING WATER SERVICES FOR CLARITY AND SHALL BE INSTALLED ALONG THE SAME ALIGNMENT.
  - THE DISTRICT WILL SHUT DOWN THE EXISTING WATER MAIN FOR A PERIOD OF 4 HOURS TO PERMIT THE CONTRACTOR TO REMOVE SUFFICIENT LENGTH OF WATER MAIN AND CONNECT THE PROPOSED NEW WATER MAIN TO THE EXISTING WATER MAIN.
  - WHEN REMOVING ASBESTOS CEMENT PIPE, THE CONTRACTOR SHALL TAKE ALL MEASUREMENTS NECESSARY TO COMPLY WITH REQUIREMENTS SET BY NESHAP AND OSHA.
  - GATE VALVE AND AIR RELEASE SEE DETAIL ON SHEET W-0.6.

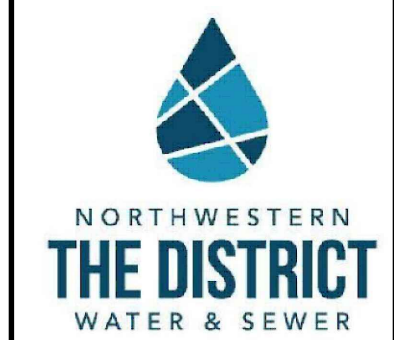
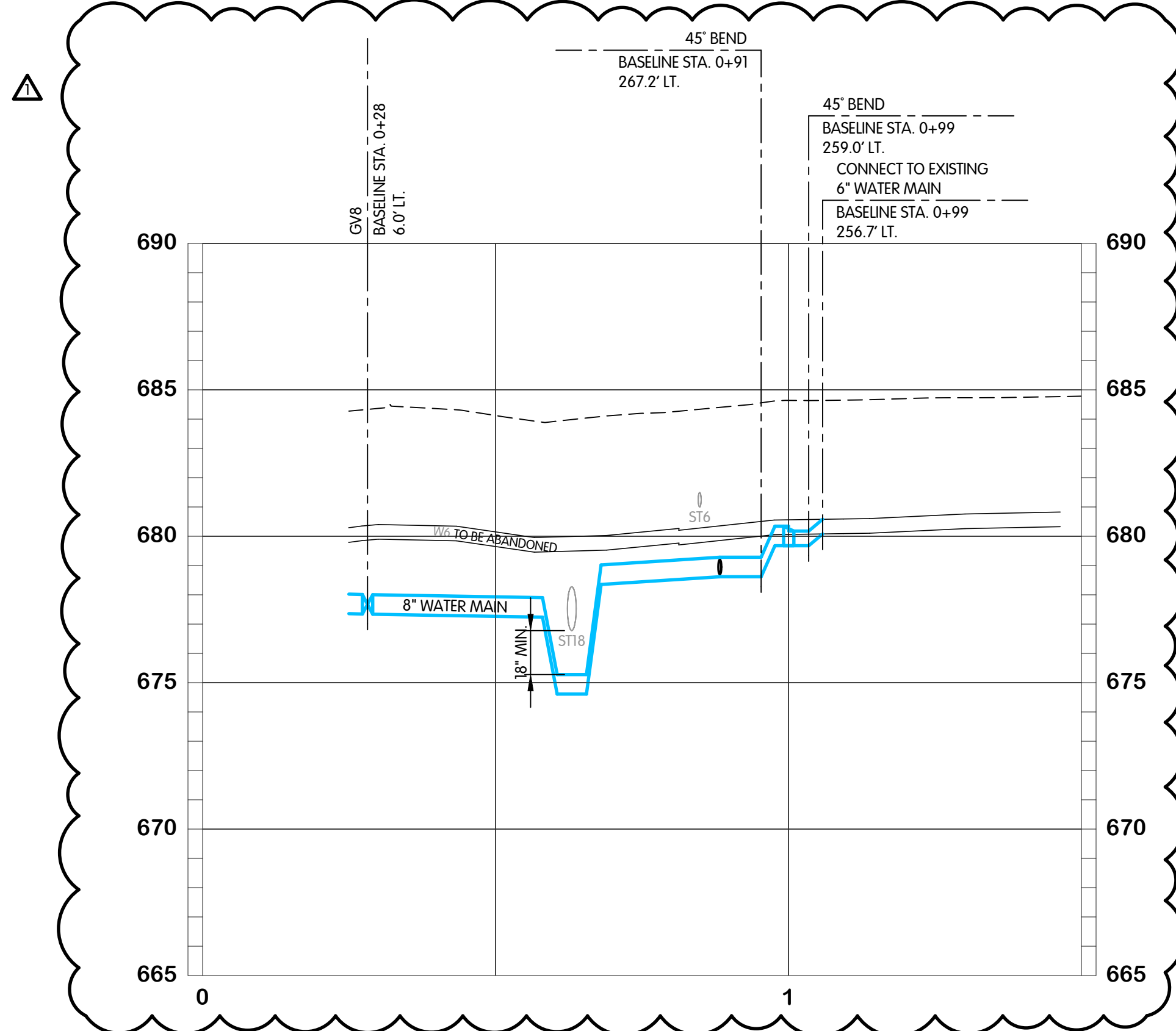

WATER STREET  
 WATER  
 PLAN AND PROFILE  
 STA. 0+00 TO 1+00  
 NORTHWESTERN WATER & SEWER DISTRICT  
 2024 PORTAGE WATER MAIN REPLACEMENT

REVISIONS AFTER ISSUED FOR BID  
 NO. DATE  
 1 8/8/2024 ADDENDUM 1  
 2  
 3  
 4  
 5

Jones & Henry  
 Engineers, Ltd.  
  
 Fluid thinking.<sup>®</sup>  
 www.JHeng.com

JOB NO. 796-8122.001  
 SCALE 1"=20' HOR.  
 1"=4' VERT.  
 THIS LINE SCALES IF WHEN PLOTTED TO NOTED SCALE  
 DESIGNED EAF DRAWN DJK CHECKED TAB  
 STATUS ISSUED FOR BID  
 DATE MAY 2024  
 SHEET NO. W-2.1  
 9 OF 25



**SOUTH FINDLAY PIKE  
SURFACE RESTORATION  
PLANS**

STA. 0+00 TO 11+00  
NORTHWESTERN WATER & SEWER DISTRICT  
2024 PORTAGE WATER MAIN REPLACEMENT

REVISIONS AFTER ISSUED FOR BID

Jones & Henry  
Engineers, Ltd.



Fluid thinking.<sup>®</sup>  
www.JHeng.com

JOB NO. 796-8122.001

SCALE 1"=20' AS INDICATED

THIS LINE SCALES IF WHEN PLOTTED TO NOTED SCALE

DESIGNED	DRAWN	CHECKED
EAF	DJK	TAB

STATUS: ISSUED FOR BID

DATE: MAY 2024

SHEET NO.

SR-1.1-2

19 OF 25

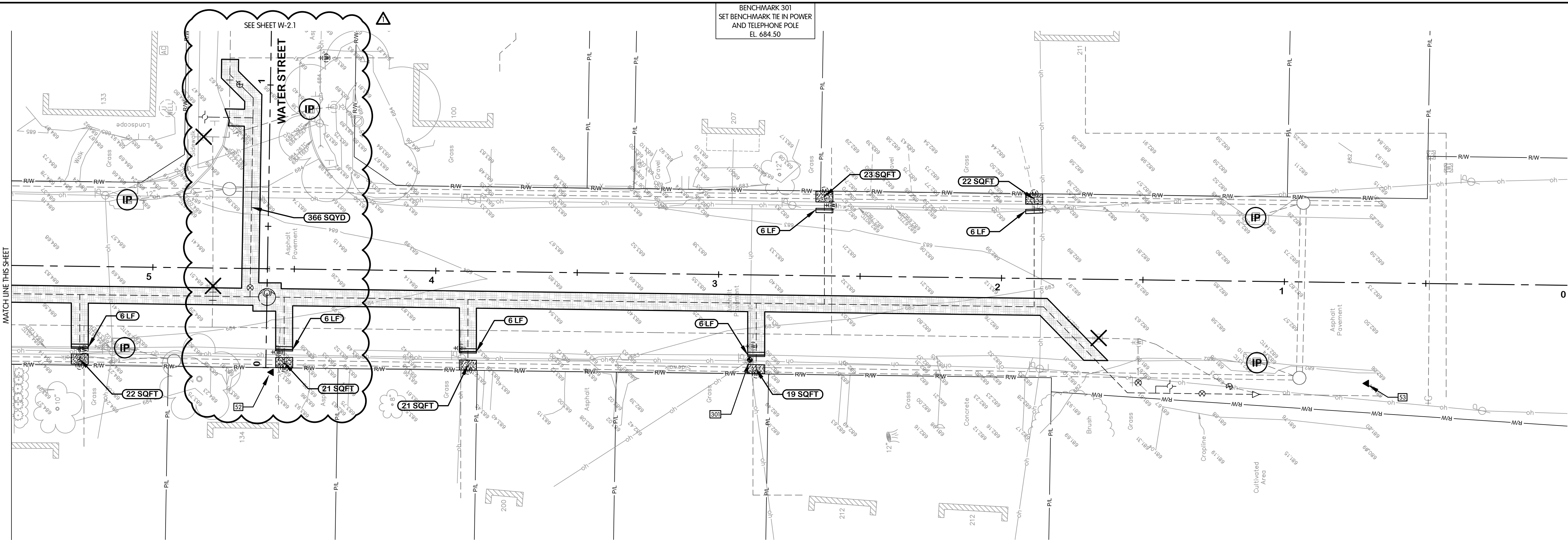

- LEGEND**
- INLET PROTECTION, SEE DETAIL ON SHEET EC-1
  - CURB, SEE DETAILS ON SHEET SR-0.1
  - COMBINATION CURB AND SIDEWALK, SEE DETAILS ON SHEET SR-0.1
  - 6-INCH CONCRETE DRIVE REPAIR, SEE DETAIL ON SHEET SR-0.2
  - ASPHALT PAVEMENT REPAIR - HEAVY ROADWAY, SEE DETAIL ON SHEET SR-0.1
  - 6-INCH CONCRETE SIDEWALK, SEE DETAIL ON SHEET SR-0.3
  - 4-INCH CONCRETE SIDEWALK, SEE DETAIL ON SHEET SR-0.1
  - ASPHALT PAVEMENT REPAIR - RESIDENTIAL ROADWAY, SEE DETAIL ON SHEET SR-0.1

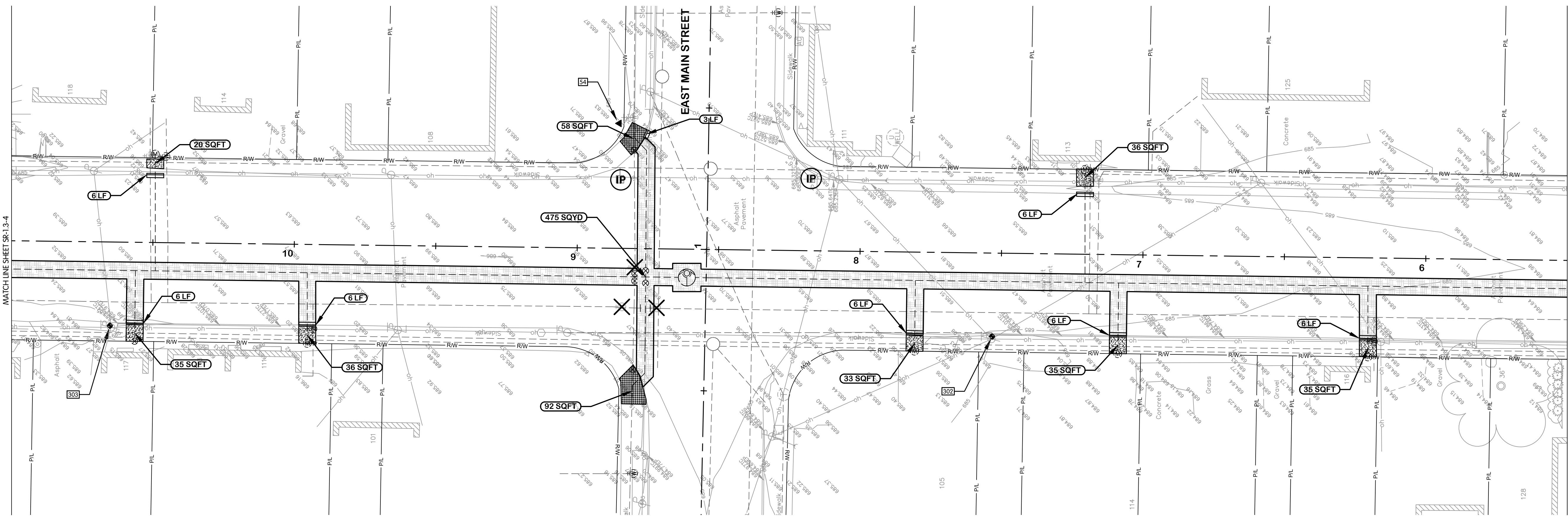

BENCHMARK 302  
SET BENCHMARK TIE IN POWER  
AND TELEPHONE POLE  
EL. 686.72

BENCHMARK 303  
SET BENCHMARK TIE IN POWER  
AND TELEPHONE POLE  
EL. 686.42

TOL-8122001SR-SR-1.1-2 S FINDLAY STA. 0+00 TO 11+00  
8/8/2024, 12:53 PM - DKOLLAR  
8/8/2024, 12:59 PM



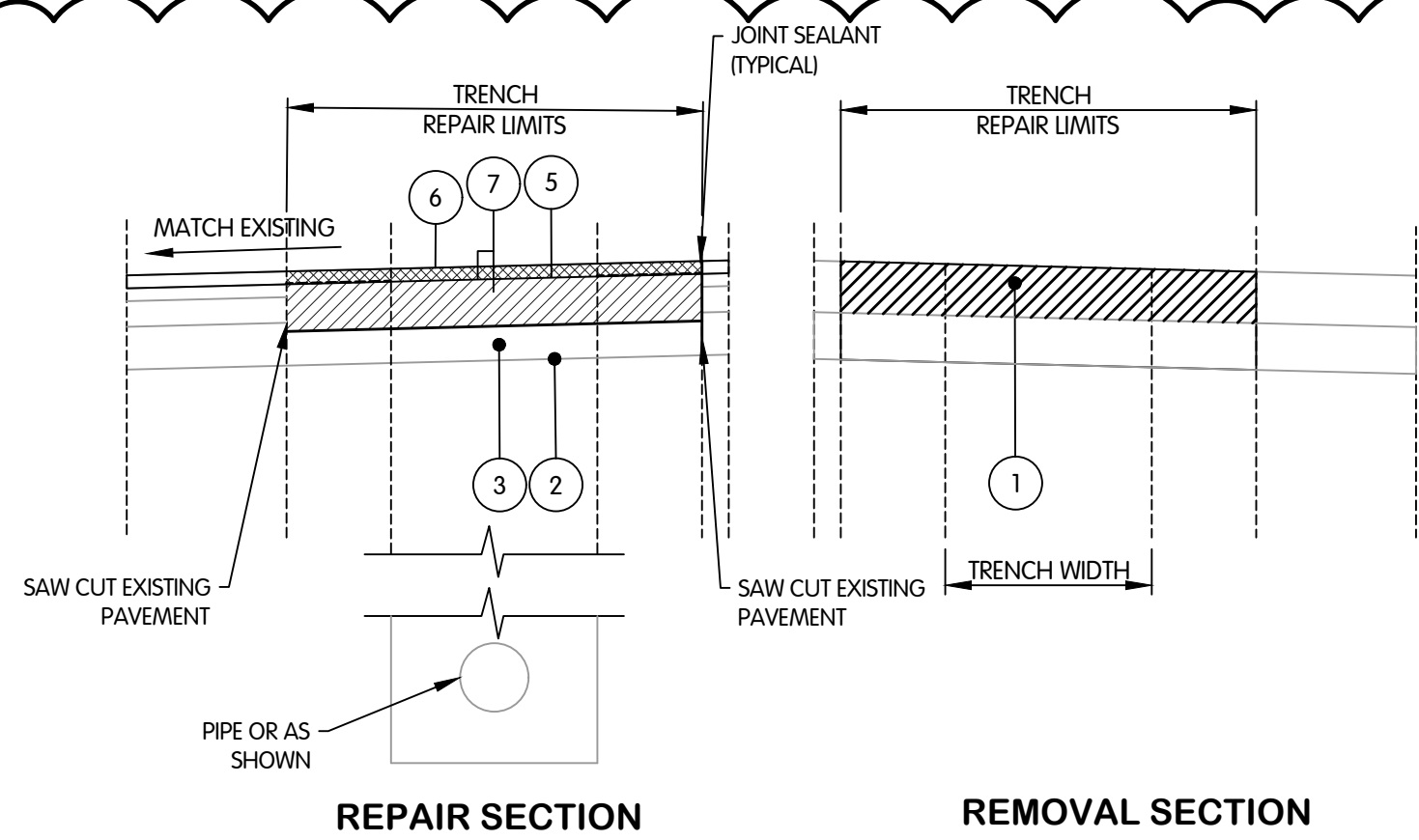

**PAVEMENT TRENCH REPAIR TYPICAL SECTION  
(RESIDENTIAL PAVEMENT) - CLOSE STREET**  
NTS

- 1 ITEM 202 - PAVEMENT AND BASE REMOVED (12" MAX) ADDITIONAL PAVEMENT AND BASE REMOVAL DEPTH TO BE INCLUDED IN THE COST OF THE PIPE.
- 2 ITEM 204 - SUBGRADE COMPACTION
- 3 ITEM 304 - AGGREGATE BASE (12")
- 4 1 3/4" ITEM 441 ASPHALT CONCRETE INTERMEDIATE COURSE, TYPE 2 (449)
- 5 1/2" ITEM 441 ASPHALT CONCRETE SURFACE COURSE, TYPE 1 (449) [SEE PAVEMENT PLANNING TYPICAL SECTION]
- 6 ITEM 407 TACK COAT - 0.050 GAL/SY. USE RUBBERIZED ASPHALT EMULSION IN ACCORDANCE WITH 703.12 BETWEEN ASPHALT AND CONCRETE SURFACES. (TRENCH AREAS ONLY)

NOTE:  
THE PAVEMENT SECTION SHALL BE DEFINED AS THE PAVEMENT AND AGGREGATE BASE THICKNESS SHOWN IN THESE TYPICAL SECTIONS FOR THE PURPOSE OF BID ITEM DIVISIONS (PIPE AND PAVEMENT)

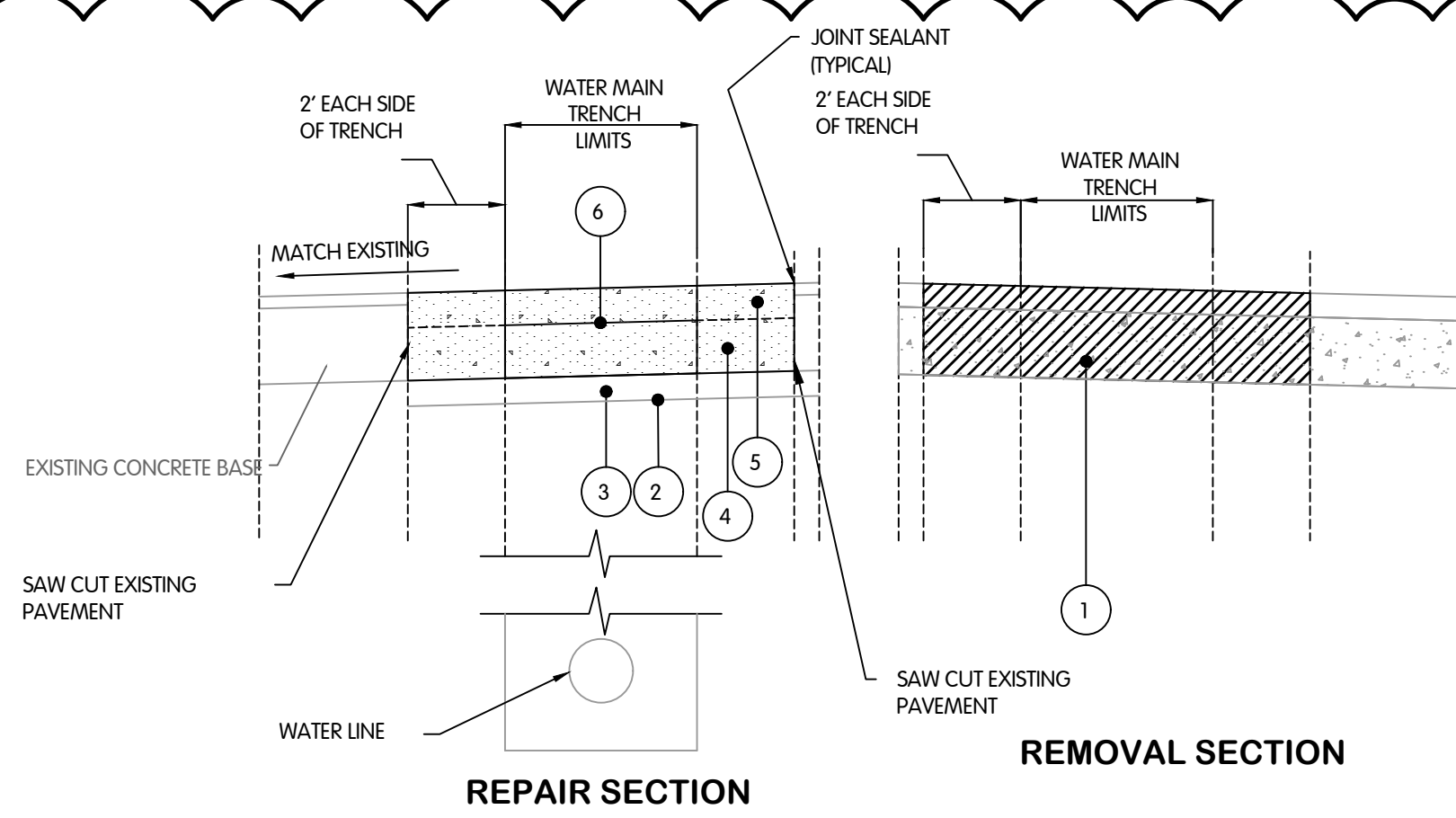

**PAVEMENT TRENCH REPAIR TYPICAL SECTIONS  
(HEAVY ROADWAY) FINDLAY PIKE**

- 1 ITEM 202 - PAVEMENT AND BASE REMOVED (18" MAX) ADDITIONAL PAVEMENT AND BASE REMOVAL DEPTH TO BE INCLUDED IN THE COST OF THE WATERMAIN.
- 2 ITEM 204 - SUBGRADE COMPACTION
- 3 ITEM 304 - AGGREGATE BASE (6" MIN)
- 4 ITEM 452 - NON-REINFORCED CONCRETE PAVEMENT (10" MINIMUM). TIE BARS OR HOOK BOLTS ALTERNATE ON LONGITUDINAL JOINTS (ODOT SCD BP 2.1) & DOWELS BARS ON TRANSVERSE JOINTS (ODOT SCD BP 2.2). MATCH EXISTING PAVEMENT SURFACE ELEVATION.
- 5 ITEM 301 ASPHALT CONCRETE BASE (5.5") - FOR HEAVY ROADWAY (FINDLAY PIKE) UNLESS EXISTING ASPHALT IS GREATER THAN 3"
- 6 ITEM 407 TACK COAT - 0.050 GAL/SY. USE RUBBERIZED ASPHALT EMULSION IN ACCORDANCE WITH 703.12 BETWEEN ASPHALT AND CONCRETE SURFACES. (TRENCH AREAS ONLY)

NOTES:  
1. THE PAVEMENT SECTION SHALL BE DEFINED AS THE PAVEMENT AND AGGREGATE BASE THICKNESS SHOWN IN THESE TYPICAL SECTIONS FOR THE PURPOSE OF BID ITEM DIVISIONS (PIPE AND PAVEMENT)

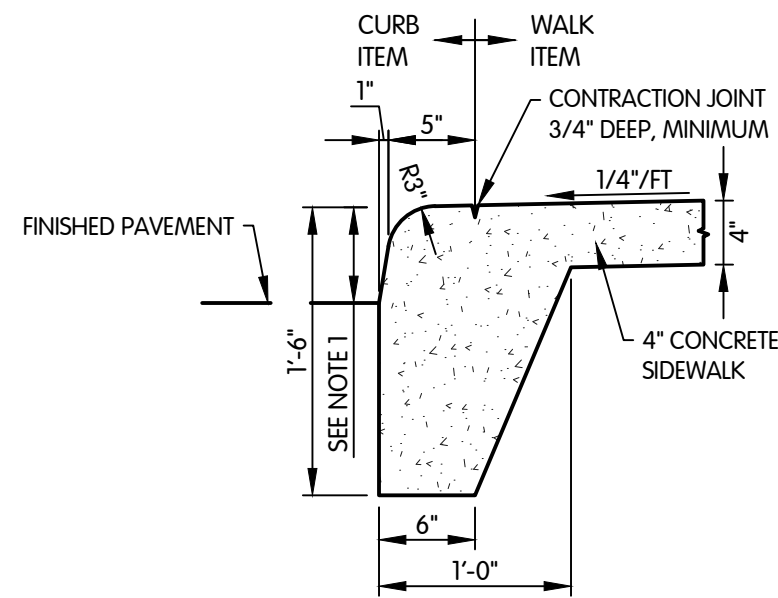

**COMBINATION CURB AND SIDEWALK**  
NTS

- NOTES:
- 1. FACE OF CURB SHALL MATCH EXISTING.
  - 2. TRANSVERSE CONTRACTION JOINTS SHALL BE SPACED AT 5' MAX. AND THE JOINT SHALL RUN THRU THE CURB PORTION.
  - 3. CONTRACTOR SHALL EXCAVATE, PREPARE, AND COMPACT THE SUBBASE AS NEEDED.

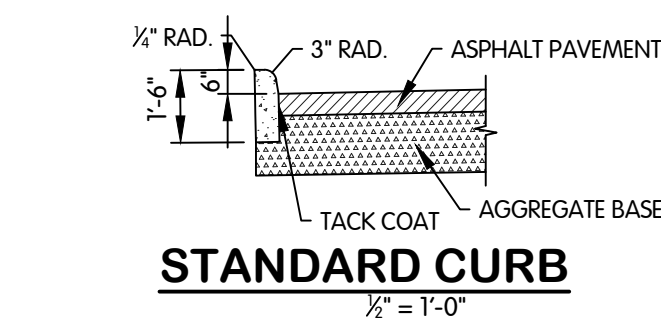

**STANDARD CURB**  
1/2" = 1'-0"

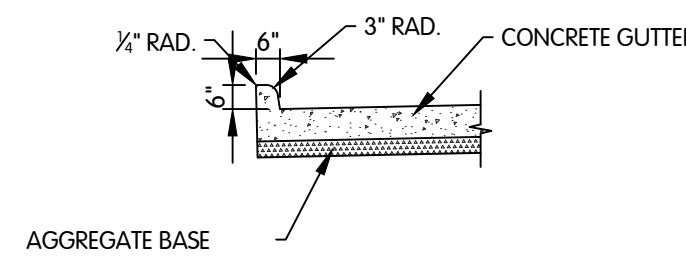

**INTEGRAL CURB**  
(ODOT TYPE 2)  
1/2" = 1'-0"

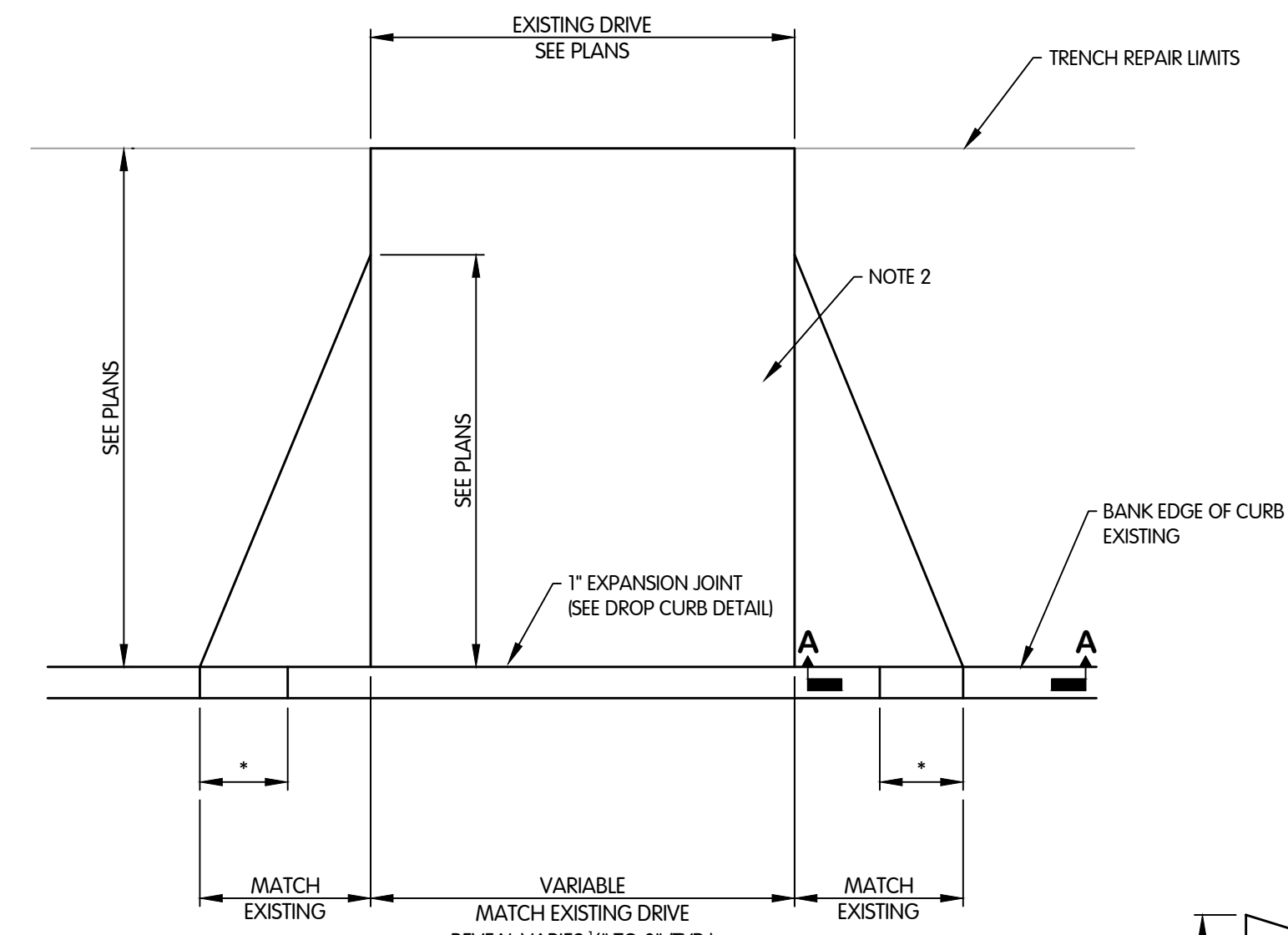

\* THE TRANSITION FROM STANDARD VERTICAL CURB SECTION TO DROP CURB SECTION IS TO BE WITHIN 18" OF DRIVEWAY. NO DROP IS REQUIRED WITH ROLL CURB.

- NOTES:
- 1. ALL DRIVES SHALL BE PLACED ON 6" ODOT ITEM 304.
  - 2. CONCRETE DRIVEWAY AND APPROACH SHALL BE 6" ODOT ITEM 452 FOR RESIDENTIAL DRIVEWAYS AND 10" ODOT ITEM 452 FOR INDUSTRIAL DRIVEWAYS. ASPHALT DRIVEWAYS SHALL MATCH EXISTING THICKNESS WITH MINIMUM THICKNESS TO BE 1/2" ODOT ITEM 441 SURFACE COURSE TYPE 1 (448), 1 1/2" ODOT ITEM 441 INTERMEDIATE COURSE TYPE 2 (448).

**DRIVEWAY APPROACH DETAIL**  
NTS

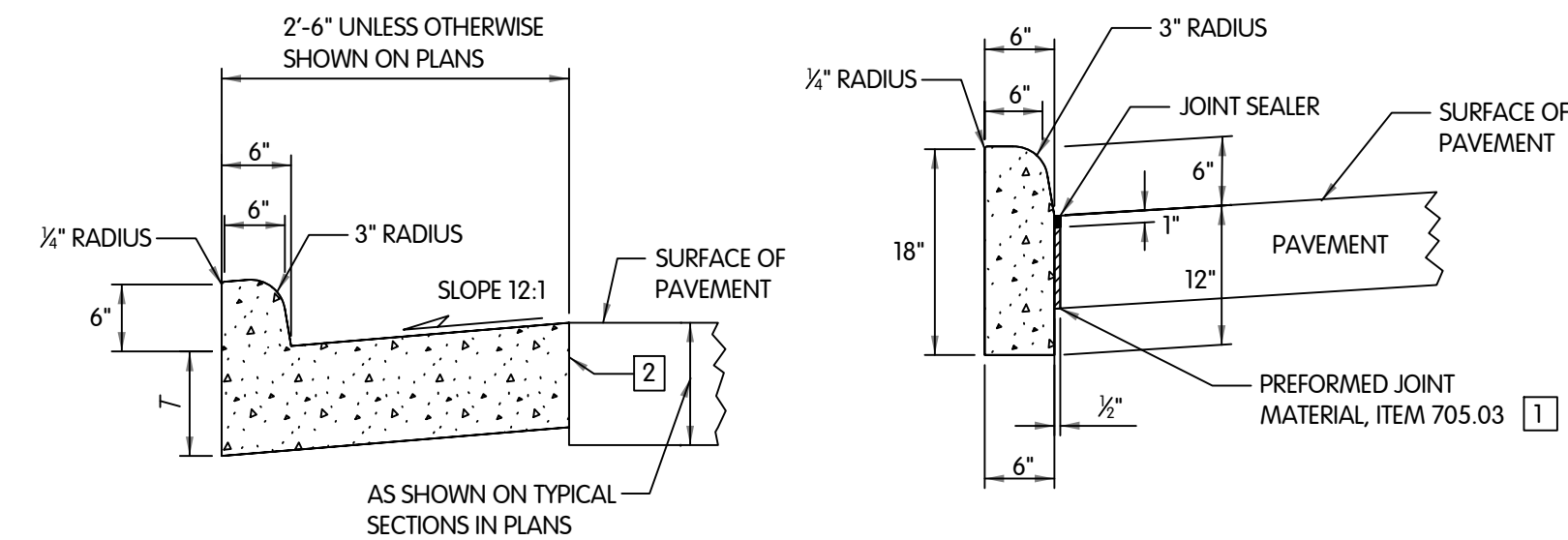

**TYPE 2**

**TYPE 6**

- 1. EXPANSION JOINT MATERIAL AND JOINT SEALER ARE NOT REQUIRED FOR THE PORTION OF THE CURB THAT IS ADJACENT TO A FLEXIBLE PAVEMENT TYPE. BOTH MATERIALS ARE REQUIRED, AS DETAILED, FOR THE FULL HEIGHT OF RIGID PAVEMENT AND CONCRETE BASES.
- 2. BUTT JOINTS SHALL BE PROVIDED BETWEEN COMBINE CURB-AND-GUTTER AND NEW OR EXISTING RIGID PAVEMENTS, WITH TIE BARS OR HOOK BOLTS PROVIDED AT INTERVALS OF 5'. SEE SCD BP-2.1 FOR DETAILS OF TIE BARS AND HOOK BOLTS. IF THE COMBINED CURB-AND-GUTTER ADJOINS A NEW RIGID BASE OR AN EXISTING RIGID BASE OR PAVEMENT THAT IS TO BE SURFACED WITH ASPHALT CONCRETE, A BUTT JOINT SHALL ALSO BE PROVIDED. HOWEVER, TIE BARS OR HOOK BOLTS SHALL BE OMITTED WHEN THE VERTICAL OVERLAP (V) IN DETAIL BELOW BETWEEN THE CURB-AND-GUTTER AND RIGID PAVEMENT IS LESS THAN 7".

**ODOT CURB TYPE DETAILS**  
NTS

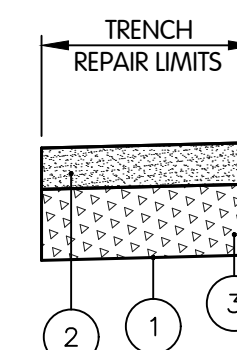

- 1 ITEM 204 - SUBGRADE COMPACTION
- 2 ITEM 411 - 6" COMPACTED AGGREGATE WEARING COURSE (BERM)
- 3 ITEM 304 - 6" AGGREGATE BASE

**GRAVEL ROAD DRIVEWAY AND BERM REPAIR SECTION**  
NTS

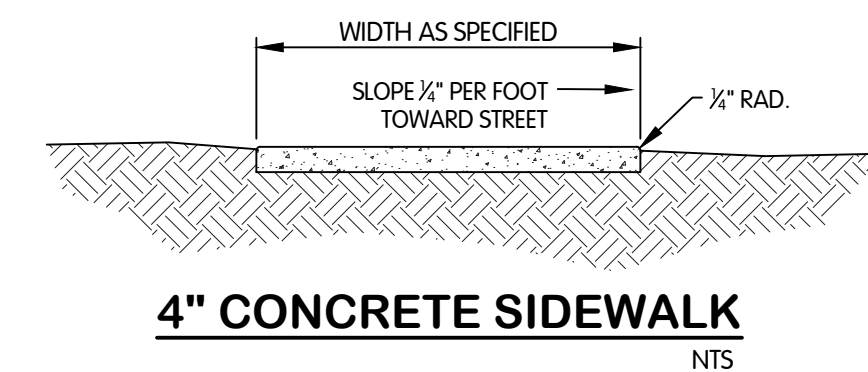

**4" CONCRETE SIDEWALK**  
NTS



**UNIT PRICE BID**

Bidder acknowledges that (1) each Bid Unit Price includes an amount considered by Bidder to be adequate to cover Contractor's overhead and profit for each separately identified item, and (2) estimated quantities are not guaranteed, and are solely for the purpose of comparison of Bids, and final payment for all unit price Bid items will be based on actual quantities, determined as provided in the Contract Documents.

ITEM NO.	ITEM DESCRIPTION	ESTIMATED AMOUNT	UNIT	UNIT PRICE IN NUMBERS		UNIT PRICE IN WORDS		MATERIAL UNIT PRICE IN NUMBERS		LABOR UNIT PRICE IN NUMBERS		TOTAL ESTIMATED COST OF ITEM IN WORDS		TOTAL ESTIMATED COST OF ITEM	
1	Mobilization and Demobilization	1	LS												
2a	6-inch Water Main, Type B	66	LF												
2b	6-inch Water Main, Type C	13	LF												
2c	8-inch Water Main, Type B	283	LF												
2d	8-inch Water Main, Type C	10	LF												
2e	10-inch Water Main, Type B	10	LF												
2f	10-inch Water Main, Type C	10	LF												
2g	12-inch Water Main, Type B	2540	LF												
2h	12-inch Water Main, Type C	70	LF												
2i	Connection to Existing Water Mains 12-inch and Smaller (Without Tapping)	10	EA												
2j	Existing Water Main Plugged	16	EA												
2k	Water Main Termination and Abandonment	5	EA												
3a	6-inch Gate Valve and Box	1	EA												
3b	8-inch Gate Valve and Box	5	EA												
3c	12-inch Gate Valve and Box	3	EA												
3d	12-inch Gate Valve and Manhole	5	EA												
3e	Valve Box Abandoned	8	EA												
3f	Valve Box Removed	2	EA												
4a	Fire Hydrant Assembly, Type A	4	EA												
4b	Fire Hydrant Assembly, Type B	1	EA												
4c	Fire Hydrant Assembly Removed	5	EA												

ITEM NO.	ITEM DESCRIPTION	ESTIMATED AMOUNT	UNIT	UNIT PRICE IN NUMBERS		UNIT PRICE IN WORDS		MATERIAL UNIT PRICE IN NUMBERS		LABOR UNIT PRICE IN NUMBERS		TOTAL ESTIMATED COST OF ITEM IN WORDS		TOTAL ESTIMATED COST OF ITEM	
5a	Trenchless Water Service (Less than 2-inch diameter)	632	LF												
5b	Water Service (Less than 2-inch diameter)	367	LF												
5c	Water Service Connection Reinstated (Less than 2-inch diameter)	39	EA												
5d	Tandem Water Meter Pits (Without Meter)	5	EA												
5e	Water Meter Pits (Without Meter)	27	EA												
6a	Flexible Pavement Trench Repair - Residential Roadway	31	SY												
6b	Flexible Pavement Trench Repair - Heavy Roadway	2114	SY												
6c	Temporary Pavement Repair	2123	SY												
7a	6-inch ODOT Item 452 Non-Reinforced Concrete Pavement, Class MS (Residential Drive Approach)	30	SY												
7b	4-inch Concrete Sidewalk	1084	SF												
7c	6-inch Concrete Sidewalk and Curb Ramp with Detectable Warning Surface	512	SF												
8	Concrete Curb	207	LF												
9a	Sewer Repair (Less than or equal to 10-inch diameter)	30	LF												
9b	Sewer Repair (12-inch diameter to 18-inch diameter)	60	LF												
10	Video Recording of the Zone of Influence	1	LS												
11	Maintenance of Traffic	1	LS												
12	Storm Water Pollution Prevention	1	LS												
13	Clearing and Grubbing	1	LS												
14	Rock Excavation	1100	LF												
Allowance	Utility Pole Holding	1	LS										Five Thousand Dollars and Zero Cents		\$5,000
<b>Total Estimated Construction Cost:</b>															