



Northwestern Water and Sewer District
2025 NWSD 100 Area Waterline Improvements
WL-100E

ADDENDUM 5

December 31, 2024

Planholders of the Northwestern Water and Sewer District 2025 NWSD 100 Area Waterline Improvements, WL-100E, project are hereby notified of the following amendments to the Contract Documents. This Addendum is hereby made a part of the Contract Documents.

DRAWINGS

- Replace Sheet G-1-0.7 with the attached G-1-0.7.
- Replace Sheet G-2-0.8 with the attached G-2-0.8.
- Replace Sheet G-3-0.9 with the attached G-3-0.9.
- Replace Sheet G-4-0.10 with the attached G-4-0.10.
- Replace Sheet G-5-0.11 with the attached G-5-0.11.
- Replace Sheet W-2-1.4 with the attached W-2-1.4.
- Replace Sheet W-3-1.1 with the attached W-3-1.1.

SPECIFICATIONS

Page 01010

Remove Specification 01010 in its entirety and replace with the attached Specification 01010.
It adds Bid Items for 3-inch Gate Valve and Box, and 4-inch Gate Valve and Box.

Page C-400-6 – C-400-9

Remove pages C-400-6 through C-400-9 in their entirety and replace with the attached C-400-6 – C-400-9.

A link to an updated excel bid form will provided on a future Addendum.

QUESTIONS

The following questions were submitted to the Engineer. The answers provided below are for the clarification of Bidders questions. Questions have been paraphrased for brevity.

Question #1 – What is the purpose of Article 36?

This Article is included to meet requirements set forth by the Ohio EPA.

Question #2 – Are 3-inch and 4-inch services to have meter pits installed?



**Northwestern Water & Sewer District
2025 NWSD 100 Area Waterline Improvements
Addendum 5**

Please see updated Drawing Sheets. These services have been adjusted to have valves installed rather than meter pits.

Question #3 – Can Allowance be set up for Railroad Protective Insurance, flagging and inspection?

Please see Specification 01021.

RECEIPT OF THIS ADDENDUM MUST BE ACKNOWLEDGED ON PAGE C-410 - 1 OF THE BID.

UNIT PRICE BID

Bidder acknowledges that (1) each Bid Unit Price includes an amount considered by Bidder to be adequate to cover Contractor's overhead and profit for each separately identified item, and (2) estimated quantities are not guaranteed, and are solely for the purpose of comparison of Bids, and final payment for all unit price Bid items will be based on actual quantities, determined as provided in the Contract Documents.

ITEM NO.	ITEM DESCRIPTION	ESTIMATED AMOUNT	UNIT	UNIT PRICE IN NUMBERS		UNIT PRICE IN WORDS	MATERIAL UNIT PRICE IN NUMBERS		LABOR UNIT PRICE IN NUMBERS		TOTAL ESTIMATED COST OF ITEM IN WORDS	TOTAL ESTIMATED COST OF ITEM	
1	Mobilization and Demobilization	1	LS										
2a	4-inch Water Main, Type B	40	LF										
2b	4-inch Water Main, Type C	10	LF										
2c	6-inch Water Main, Type B	100	LF										
2d	6-inch Water Main, Type C	10	LF										
2e	8-inch Water Main, Type B	5100	LF										
2f	8-inch Water Main, Type C	400	LF										
2g	8-inch Water Main, Trenchless	100	LF										
2h	10-inch Water Main, Type B	1084	LF										
2i	10-inch Water Main, Type C	290	LF										
2j	12-inch Water Main, Type B	1810	LF										
2k	12-inch Water Main, Type C	4100	LF										
2l	12-inch Water Main, Trenchless	5260	LF										
2m	16-inch Water Main, Type B	2290	LF										
2n	16-inch Water Main, Type C	3234	LF										
2o	16-inch Water Main, Trenchless	232	LF										
2p	16-inch Water Main in 30-inch Bored Casing	250	LF										
2q	20-inch Water Main, Type B	20	LF										
2r	Connection to Existing Water Mains 12-inch and Smaller (Without Tapping)	18	EA										
2s	Connection to Existing Water Mains Larger than 12-inch (Without Tapping)	6	EA										
2t	Existing Water Main Plugged	38	EA										
2u	Water Main Termination and Abandonment	22	EA										

ITEM NO.	ITEM DESCRIPTION	ESTIMATED AMOUNT	UNIT	UNIT PRICE IN NUMBERS		UNIT PRICE IN WORDS	MATERIAL UNIT PRICE IN NUMBERS		LABOR UNIT PRICE IN NUMBERS		TOTAL ESTIMATED COST OF ITEM IN WORDS	TOTAL ESTIMATED COST OF ITEM	
3a	3-inch Gate Valve and Box	2	EA										
3b	4-inch Gate Valve and Box	1	EA										
3c	6-inch Gate Valve and Box	2	EA										
3d	8-inch Gate Valve and Box	19	EA										
3e	10-inch Gate Valve and Box	3	EA										
3f	12-inch Gate Valve and Manhole	17	EA										
3g	16-inch Butterfly Valve and Manhole	6	EA										
3h	10-inch by 8-inch Tapping Sleeve, Valve and Box	1	EA										
3i	16-inch Tapping Valve and Box	1	EA										
3j	24-inch by 12-inch Tapping Sleeve, Valve and Box	1	EA										
3k	Valve Box	1	EA										
3l	Valve Box Abandoned	8	EA										
3m	Valve Box Removed	1	EA										
3n	Valve Manhole Abandoned	27	EA										
3o	Valve Manhole Removed	8	EA										
4a	Fire Hydrant Assembly, Type A	29	EA										
4b	Fire Hydrant Assembly, Type B	38	EA										
4c	Fire Hydrant Assembly, Type C	1	EA										
4d	Fire Hydrant Assembly, Type SC	5	EA										
4e	Fire Hydrant Assembly Removed	46	EA										
5a	Water Service (Less than 2-inch diameter)	1701	LF										
5b	Water Service (2-inch diameter and greater)	20	LF										

ITEM NO.	ITEM DESCRIPTION	ESTIMATED AMOUNT	UNIT	UNIT PRICE IN NUMBERS		UNIT PRICE IN WORDS	MATERIAL UNIT PRICE IN NUMBERS		LABOR UNIT PRICE IN NUMBERS		TOTAL ESTIMATED COST OF ITEM IN WORDS	TOTAL ESTIMATED COST OF ITEM	
5c	Trenchless Water Service (Less than 2-inch diameter)	3892	LF										
5d	Water Service Connection Reinstated (Less than 2-inch diameter)	180	EA										
5e	Water Service Connection Reinstated (2-inch diameter and greater)	4	EA										
5f	Water Meter Pit Installation	180	EA										
6a	Flexible Pavement Trench Repair - Heavy Roadway	5779	SY										
6b	Flexible Pavement Trench Repair - Residential Roadway	282	SY										
6c	Flexible Pavement Trench Repair - Driveway	454	SY										
6d	Temporary Pavement Repair	6479	SY										
6e	ODOT Item 411 Stabilized Crushed Aggregate (Berm and Drive)	273	SY										
6f	Flexible Pavement Planing and Resurfacing	4976	SY										
7a	6-inch ODOT Item 452 Non-Reinforced Concrete Pavement, Class MS (Residential Drive Approach)	466	SY										
7b	4-inch Concrete Sidewalk	8508	SF										
7c	6-inch Concrete Sidewalk and Curb Ramp with Detectable Warning Surface	353	SF										
8a	Concrete Curb	30	LF										
8b	Concrete Curb and Gutter	231	LF										
9	Remove and Replace Catch Basin	11	EA										
10a	Sewer Repair (Less than or equal to 10-inch diameter)	120	LF										
10b	Sewer Repair (12-inch diameter to 18-inch diameter)	120	LF										
10c	Sewer Repair (21-inch diameter and larger)	55	LF										
10d	New Cleanout on Lateral (Non-Paved Area)	1	EA										
11	Video Recording of the Zone of Influence	1	LS										

ITEM NO.	ITEM DESCRIPTION	ESTIMATED AMOUNT	UNIT	UNIT PRICE IN NUMBERS		UNIT PRICE IN WORDS	MATERIAL UNIT PRICE IN NUMBERS		LABOR UNIT PRICE IN NUMBERS		TOTAL ESTIMATED COST OF ITEM IN WORDS	TOTAL ESTIMATED COST OF ITEM	
12	CCTV Inspections of Sewers	1402	LF										
13	Maintenance of Traffic	1	LS										
14	Storm Water Pollution Prevention	1	LS										
15	Clearing and Grubbing	1	LS										
16	East Broadway Blow-off Manhole Access	1	LS										
17a	Remove and Replace Sign	10	EA										
17b	Remove and Replace Mailbox	20	EA										
18	Remove Existing Water Main	229	LF										
19	Remove and Replace Fence	370	EA										
Allowance	Utility Pole Holding	1	LS	\$5,000.00		Five thousand dollars and zero cents					Five thousand dollars and zero cents	\$5,000.00	
Allowance	Railroad Liability Insurance	1	LS	\$10,000.00		Ten thousand dollars and zero cents					Ten thousand dollars and zero cents	\$10,000.00	
Total Estimated Base Bid Construction Cost:													
6f-alt	Flexible Pavement Planing and Resurfacing	7705	SY										
Total Estimated Base Bid + Alternate Bid Construction Cost:													

SECTION 01010
DEFINITION OF CONTRACT ITEMS

ITEM 0 GENERAL

0.01 FOREWORD

- A. This Section describes the various Contract Items listed in the Bid.

0.02 WORK INCLUDED

- A. Under each Item the Contractor shall furnish all labor, materials, tools, plant equipment, supplies, maintenance of equipment, heating, lighting and power, insurance and bonds, coordination, and all Work and in accordance with the Specifications Parts A, B, and Divisions 1 through 16 of Part C and necessary to complete the Work in accordance with the obvious or expressed intent of the Contract Documents.
- B. The removal and proper disposal of debris generated by work under each Item shall be included in that corresponding Item.

0.03 WORKMANSHIP AND MATERIALS

- A. The quality of workmanship and materials entering into any and all of the Items and the Work included shall conform to pertinent sections, paragraphs, sentences, and clauses, both directly and indirectly applicable thereto, contained in the Contract Documents, whether or not direct reference to such occurs under each Item in this Section.

0.04 PAYMENT

- A. The lump sum and unit prices stated in the Bid shall be payment in full for the completion of all Work specified and described or required to be included in the Contract, complete, and ready for use.

0.05 CONTRACT ITEMS

- A. The Contract Items are defined on the following pages.

**ITEM 1
MOBILIZATION AND DEMOBILIZATION**

1.01 DESCRIPTION

- A. This Item is intended to pay non-recurring cost to the Contractor not recovered under other pay Items of the Contract.
- B. This Item shall include, but not be limited to, the cost for moving equipment in and out, performance and payment bonds, insurance, permits, utility connection cost, and other expenses associated with preparation for construction in accordance with the requirements of the Contract Documents.
- C. This Item is intended to be in accordance with the Supplemental Conditions SC 15.01,A.

1.02 WORK NOT INCLUDED

- A. Any Work specifically included under other Bid Items.

1.03 DEFINITION OF ITEM

- A. Item 1 – Mobilization and Demobilization.

1.04 MEASUREMENT & PAYMENT

- A. The lump sum stated in the Bid shall be full compensation for all Work required under Item 1.
- B. The Contractor is reminded of the requirements of Supplemental Conditions Section 15.01.A regarding Mobilization and Demobilization costs as a percentage of the total project cost.
- C. Payment shall be in accordance with Supplemental Conditions 15.01, A. The Engineer may reduce the amount to be paid under Item 1 if the percentage requested is not represented by the actual amount performed.

**ITEM 2
WATER MAINS**

2.01 DESCRIPTION

- A. Under these Items, the Contractor shall furnish and perform all Work necessary for the installation of the water mains as scheduled, shown on the Drawings and specified, in conformance with relevant sections of the Specifications.
- B. These Items shall include all Work to install the water mains, including but not limited to the following: excavation; hauling excess spoil material from Site; backfill; compaction; bedding; pipe materials; fittings; maintenance of trenches; connections to existing water

mains; and related Work and materials such as blowoffs to perform disinfection, flushing, performing pressure and bacteriological tests as shown on the Drawings and specified in conformance with relevant Sections of the Specifications.

- C. Connections of new water mains to new and existing water mains shall be included under these Items. Temporary supporting of existing utilities, locating of existing utilities, exploratory excavation and backfill required by the utility owner for existing utilities encountered during construction is included under these Items.
- D. The abandonment of existing water mains, including existing pipe, fittings, and other associated appurtenances shall be included under these Items.
- E. The removal of existing water mains, including existing pipe, fittings, valves, backfill, bedding, structures, concrete encasements and other associated appurtenances incidental to water main construction shall be included under these Items.
- F. These Items shall include all water main fittings, accessories and appurtenances not included in other pay items. Fittings, including those not shown on the plans required to avoid existing utilities shall be included under these Items incidental to water main construction.
- G. The furnishing and placing of special backfill in areas excavated for this work included under these Items. No distinction is made for bore or receiving pits placed in pavements and the Contractor is expected to include the placement of the specified fill in the bore and receiving pits in unit pricing for trenchless work.
- H. All work to dewater trenches is included in these Items.
- I. All repairs of existing utilities damaged, as a result of construction, are included under these Items.
- J. Restoration of landscape surface improvements including seeding, mulching, and fertilizing all disturbed lawn areas shall be included under these Items, unless specifically included under other Items.

2.02 WORK NOT INCLUDED

- A. Pavement replacement within the Contract limits is included under other Items.
- B. Fire hydrant lead pipe is included under other Items.

2.03 DEFINITION OF ITEMS

- A. Item 2a – 4-inch Water Main, Type B.
- B. Item 2b – 4-inch Water Main, Type C.
- C. Item 2c – 6-inch Water Main, Type B.
- D. Item 2d – 6-inch Water Main, Type C.
- E. Item 2e – 8-inch Water Main, Type B.

- F. Item 2f – 8-inch Water Main, Type C.
- G. Item 2g – 8-inch Water Main, Trenchless.
- H. Item 2h – 10-inch Water Main, Type B.
- I. Item 2i – 10-inch Water Main, Type C.
- J. Item 2j – 12-inch Water Main, Type B.
- K. Item 2k – 12-inch Water Main, Type C.
- L. Item 2l – 12-inch Water Main, Trenchless.
- M. Item 2m – 16-inch Water Main, Type B.
- N. Item 2n – 16-inch Water Main, Type C.
- O. Item 2o – 16-inch Water Main, Trenchless.
- P. Item 2p – 16-inch Water Main in 30-inch Bored Casing.
- Q. Item 2q – 20-inch Water Main, Type B.
- R. Item 2r – Connection to Existing Water Mains 12-inch and Smaller (Without Tapping).
- S. Item 2s – Connection to Existing 16-inch Water Mains (Without Tapping).
- T. Item 2t – Existing Water Main Plugged.
- U. Item 2u – Water Main Termination and Abandonment.

2.04 MEASUREMENT & PAYMENT

- A. The quantities to be paid for under Items 2a through 2q shall be the horizontal length in linear feet of pipe measured parallel to the axis of the line along the surface of the ground, provided in accordance with Specifications and Drawings, with no deduction for laying length of fittings and valves. Vertical portions of the water main shall not be measured for payment.
- B. The quantities to be paid under Items 2r through 2u shall be the full compensation for each water main connection to existing water main, water main plug, or termination and abandonment of existing water mains provided in accordance with the Specifications and Drawings.

ITEM 3 VALVES

3.01 DESCRIPTION

- A. Under these Items, the Contractor shall furnish and perform all Work necessary for the installation of the valves and accessories as shown on the Drawings and specified in conformance with relevant Sections of the Specifications.

- B. Valve manhole structures as required or shown in the Drawings shall be included under these Items.
- C. These Items shall include all Work to install, abandon valves, including but not limited to the following: excavation; removal of concrete encasements; hauling excess spoil material from Site; backfill; compaction; bedding; pipe materials; fittings and pipe connections; and related Work such as performing material testing.
- D. The furnishing and placing of special backfill in areas excavated for this work is included under these Items.

3.02 WORK NOT INCLUDED

- A. Pavement replacement within Contract limits is included for payment under other Items.
- B. 6-inch gate valves associated with fire hydrant assemblies are included under other Items.

3.03 DEFINITION OF ITEMS

- A. Item 3a – 3-inch Gate Valve and Box.
- B. Item 3b – 4-inch Gate Valve and Box.
- C. Item 3c – 6-inch Gate Valve and Box.
- D. Item 3d – 8-inch Gate Valve and Box.
- E. Item 3e – 10-inch Gate Valve and Box.
- F. Item 3f – 12-inch Gate Valve and Manhole.
- G. Item 3g – 16-inch Butterfly Valve and Manhole.
- H. Item 3h – 10-inch x 8-inch Tapping Sleeve, Valve and Box.
- I. Item 3i – 16-inch Tapping Valve and Box.
- J. Item 3j – 24-inch by 12-inch Tapping Sleeve, Valve and Box.
- K. Item 3k – Valve Box.
- L. Item 3l – Valve Box Abandoned.
- M. Item 3m – Valve Box Removed.
- N. Item 3n – Valve Manhole Abandoned.
- O. Item 3o – Valve Manhole Removed.

3.04 MEASUREMENT & PAYMENT

- A. The quantities to be paid under Items 3a through 3j shall be full compensation for each valve and manhole or box provided in accordance with the Specifications and Drawings.

- B. The quantity to be paid under Item 3k shall be full compensation for each valve box installed on an existing valve provided in accordance with the Specifications and Drawings.
- C. The quantities to be paid under Items 3l, 3m, 3n and 3o be full compensation for each valve box or manhole removed or abandoned in accordance with the Specifications and Drawings.

**ITEM 4
FIRE HYDRANT ASSEMBLIES**

4.01 DESCRIPTION

- A. Under these Items, the Contractor shall furnish and perform all Work necessary for the installation of the fire hydrant assemblies, shown on the Drawings and specified, in conformance with relevant sections of the Specifications.
- B. These Items shall include all Work to install the fire hydrant assemblies, including but not limited to the following: excavation; removal of concrete encasement; hauling excess spoil material from Site; backfill; compaction; bedding; pipe materials; fittings; connections to water mains; construction, maintenance and removal of temporary access to the Work area; and related Work such as performing material testing.
- C. Fire hydrant assemblies shall include hydrant, watch valve, valve box, all 6-inch ductile iron pipe from the water main to the hydrant riser, anchoring pipe, and all associated fittings and accessories.

4.02 WORK NOT INCLUDED

- A. Pavement replacement within Contract limits is included for payment under other Items.

4.03 DEFINITION OF ITEMS

- A. Item 4a – Fire Hydrant Assembly, Type A.
- B. Item 4b – Fire Hydrant Assembly, Type B.
- C. Item 4c – Fire Hydrant Assembly, Type C.
- D. Item 4d – Fire Hydrant Assembly, Type SC.
- E. Item 4e – Fire Hydrant Assembly Removed.

4.04 MEASUREMENT & PAYMENT

- A. The quantities to be paid under Items 4a, 4b, 4c and 4d shall be the measured quantity of each fire hydrant assembly, provided in accordance with the Specifications and Drawings.
- B. The quantity to be paid under Item 4e shall be the measured quantity of each fire hydrant assembly removed, provided in accordance with the Specifications and Drawings.

**ITEM 5
WATER SERVICES**

5.01 DESCRIPTION

- A. Under these Items, the Contractor shall furnish and perform all Work necessary for the installation of the water services by both open-cut and trenchless methods, shown on the Drawings and specified, in conformance with relevant sections of the Specifications.
- B. These Items shall include all Work to install the water services, including but not limited to the following: excavation; hauling excess spoil material from Site; backfill; compaction; bedding; pipe materials; fittings; connections to existing services; construction, maintenance and removal of temporary access to the Work area; and related Work such as performing material testing.
- C. The removal of existing water services, including existing fittings, valves, structures and other associated appurtenances shall be included under these Items.
- D. All repair of existing utilities damaged during water service construction is included under these Items.
- E. Connections of new water services to existing water services as shown on the Drawings are included under these Items.
- F. The installation of meter pits shall be included under these Items. Water meters, lids, corp stops and meter pits provided by the Owner shall be installed by the Contractor.
- G. Reinstatement of existing water services to the new water mains shall be included under these Items.
- H. Restoration of landscape surface improvements including seeding, mulching, and fertilizing all disturbed lawn areas shall be included under these Items.
- I. These Items shall include all water service fittings, accessories and appurtenances not included in other pay items. Fittings, including those not shown on the plans required to avoid existing utilities shall be included under these Items.
- J. The excavation and backfill of bore and receiving pits for trenchless water service construction is included under these Items.
- K. The furnishing and placing of special backfill in areas excavated for this work included under these Items.

5.02 WORK NOT INCLUDED

- A. Pavement replacement within Contract limits is included for payment under other Items.
- B. Repairing of water services which were damaged and not planned to be replaced, by Contractor as a result of the construction, will be at the Contractor's expense.
- C. Water meters and meter pits will be provided by the Owner and are not included under these Items.

5.03 DEFINITION OF ITEMS

- A. Item 5a – Water Service (Less than 2-inch diameter).
- B. Item 5b – Water Service (2-inch diameter and greater).
- C. Item 5c – Trenchless Water Service (Less than 2-inch diameter).
- D. Item 5d – Water Service Connection Reinstated (Less than 2-inch diameter).
- E. Item 5e – Water Service Connection Reinstated (2-inch diameter and greater).
- F. Item 5f – Water Meter Pit Installation.

5.04 MEASUREMENT & PAYMENT

- A. The quantities to be paid for under Items 5a through 5c shall be the horizontal length in linear feet of pipe measured parallel to the axis of the line along the surface of the ground, provided in accordance with the Specifications and Drawings, with no deduction for laying length of fittings, meter vaults and valves. Vertical portions of the water service shall not be measured for payment.
- B. The quantities to be paid under Items 5d and 5e shall be full compensation for each water service connection reinstated, provided in accordance with the Specifications and Drawings.
- C. The quantity to be paid under Item 5f shall be full compensation for each meter pit installed, provided in accordance with the Specifications and Drawings.

**ITEM 6
FLEXIBLE PAVEMENT REPAIR**

6.01 DESCRIPTION

- A. Under these Items, the Contractor shall construct aggregate base, flexible pavement base and surface courses to replace pavement removed for pipeline construction as scheduled, shown on the Drawings and specified herein.
- B. The saw-cutting and preparation of the trench excavation both prior to the removal pavement for trench construction and for new pavement placement is included in these Items.
- C. The disposal of debris generated by work performed under these Items is included in these Items.
- D. Under these Items, the Contractor shall construct aggregate base, flexible pavement base and surface courses to replace pavement removed for pipeline construction as scheduled, shown on the Drawings and specified herein.
- E. The preparation of subgrade material prior to the placement of roadway base is included in these Items.

- F. The provision of the specified compaction testing is included in these Items.
- G. Bonding coats of prime or tack coats as specified are included in these Items.
- H. The provision of temporary pavement to maintain traffic is included in these Items.
- I. The repair of pavement markings damaged by the Work is included in these Items.

6.02 WORK NOT INCLUDED

- A. Pavement replacement required beyond specified pay limits for construction of manholes and chambers is included for payment under other Items.

6.03 DEFINITION OF ITEMS

- A. Item 6a – Flexible Pavement Trench Repair - Heavy Roadway.
- B. Item 6b – Flexible Pavement Trench Repair - Residential Roadway.
- C. Item 6c – Flexible Pavement Trench Repair - Driveway.
- D. Item 6d – Temporary Pavement Repair.
- E. Item 6e – ODOT Item 411 Stabilized Crushed Aggregate (Berm and Drive).
- F. Item 6f – Flexible Pavement Planing and Resurfacing.

6.04 MEASUREMENT

- A. Quantities to be paid for under these Items shall be the actual quantity constructed, measured in place within the limits as defined below, and scheduled on the Drawings, unless otherwise authorized by the Engineer; in which case, measurement will be made to the authorized limits. When uniform courses are specified, the volume to be paid for shall not exceed the quantity calculated from plan lines and dimensions. Bituminous materials will be measured in gallons at 60-degrees F applied at the specified rates and within the pay limits.
- B. Pay Limits:
 - 1. Depth - As specified, scheduled, or directed by the Engineer. To differentiate from special backfill material provided to backfill pipes and appurtenance excavations, aggregate base shall only be measured for the thickness shown on the Drawings or directed by the Engineer.
 - 2. Length - The actual length measured.
 - 3. Width:
 - a. Except as otherwise scheduled on the Drawings, the width of replacement over pipe trenches shall not exceed the nominal diameter of the pipe plus 2-1/2 feet on each side for trench depths of 16 feet and less; and 4 feet on each side for trench depths greater than 16 feet. No

additional width will be allowed for precast manholes or manhole chamber construction.

4. Trench depth as used herein shall mean the distance from the original surface of the pavement to the invert grade of the main line pipe.

6.05 PAYMENT

- A. The unit prices stated in the Bid for Items 6a, 6b, 6c and 6e shall be full compensation for each square yard of roadway or driveway removed and repaired with flexible pavement including all specified pavement materials down to the bottom of the aggregate base course and with lift thicknesses defined by typical Sections, provided in accordance with the Specifications and Drawings.
- B. The unit price stated in the Bid for Item 6d shall be full compensation for each square yard of temporary pavement placed with the prescribed limits provided in accordance with the Specifications and Drawings.
- C. The unit price stated in the Bid for Item 6f shall be full compensation for each square yard of roadway planed and resurfaced provided in accordance with the Specifications and Drawings.

ITEM 7 RIGID PAVEMENT REPAIR

7.01 DESCRIPTION

- A. Under this Item, the Contractor shall construct aggregate base, rigid pavement base and surface courses to replace pavement removed for pipeline construction as scheduled, shown on the Drawings and specified herein.
- B. The preparation of subgrade material prior to the placement of roadway base is included in this Item.
- C. The provision of the specified compaction testing is included in this Item.
- D. Any concrete pavement or base discovered will be measured and paid as approach.

7.02 WORK NOT INCLUDED

- A. Pavement replacement required beyond specified pay limits.
- B. The replacement of non-rigid pavement base, intermediate and surface courses is included under other Items.
- C. The replacement of curbs is included under other Items.

7.03 DEFINITION OF ITEMS

- A. Item 7a – 6-inch ODOT Item 452 Non-Reinforced Concrete Pavement, Class MS (Residential Drive Approach).
- B. Item 7b – 4-Inch Concrete Sidewalk.
- C. Item 7c – 6-inch Concrete Sidewalk and Curb Ramp with Detectable Warning Surface.

7.04 MEASUREMENT

- A. The quantity to be paid for under this Item shall be the actual quantity constructed, measured in place within the limits as defined below, and/or scheduled on the Drawings, unless otherwise authorized by the Engineer; in which case, measurement will be made to the authorized limits. When uniform courses are specified, the volume to be paid for shall not exceed the quantity calculated from plan lines and dimensions.
- B. Pay Limits:
 - 1. Depth - As specified, scheduled, or ordered. Trench depth as used herein shall mean the distance from the original surface of the pavement to the invert grade of the main line pipe.
 - 2. Length - The actual length ordered.
 - 3. Width - Except as otherwise scheduled on the Drawings, the width of replacement over pipe trenches shall not exceed the nominal diameter of the pipe plus 2-1/2 feet on each side for trench depths 16 feet and less and 4 feet on each side for trench depths greater than 16 feet. No additional width will be allowed for precast manholes or manhole chamber construction.

7.05 PAYMENT

- A. The unit price stated in the Bid for Item 7a shall be full compensation for each square yard of rigid pavement removed and replaced within the prescribed limits down to the bottom of the aggregate base course provided in accordance with the Specifications and Drawings.
- B. The unit prices stated in the Bid for Items 7b and 7c shall be full compensation for each square foot of rigid pavement removed and replaced within the prescribed limits as specified, so measured.

**ITEM 8
REPLACEMENT OF CONCRETE CURBS**

8.01 DESCRIPTION

- A. Under these Items, the Contractor shall remove and replace concrete curbs and gutters as scheduled, shown on the Drawings and specified herein.

8.02 WORK NOT INCLUDED

- A. Curbs and gutters damaged or destroyed beyond the specified limits shall be replaced at the Contractor's expense.
- B. All pavement, driveways and sidewalks made of rigid pavement or aggregate shall be included under other Items.

8.03 DEFINITION OF ITEMS

- A. Item 8a – Concrete Curb.
- B. Item 8b – Concrete Curb and Gutter.

8.04 MEASUREMENT & PAYMENT

- A. The quantities to be paid for under Items 8a and 8b shall be the length in linear feet measured along the front of the curb or curb and gutter removed and replaced provided in accordance with the Specifications and Drawings.

**ITEM 9
CATCH BASINS**

9.01 DESCRIPTION

- A. Under this Item, the Contractor shall perform all Work necessary for the construction, replacement or abandonment of catch basins as scheduled, shown on the Drawings, and specified herein.
- B. This Item shall include all Work to install the catch basins, including but not limited to the following: excavation; hauling excess spoil material from Site; backfill; compaction; bedding; pipe materials; fittings; connections to new and existing sewers; construction, maintenance and removal of temporary access to the Work area; and related Work such as performing material testing.
- C. All Work required to dewater trenches is included under this Item.
- D. Temporary supporting existing utilities, locating of existing utilities, exploratory excavation and backfill required by the utility owner for existing utilities encountered during construction is included under this Item.
- E. Restoration of landscape surface improvements including seeding, mulching, and fertilizing all disturbed lawn areas shall be included under this Item, unless specifically included under other items.
- F. This Item includes performing all Work necessary including but not limited to the materials and labor to reconnect leads to catch basins designated to be removed and replaced.

9.02 WORK NOT INCLUDED

- A. Pavement replacement within the Contract Limits is included under other Items.
- B. Sewer pipe, not including the catch basin lead, shall be included under the respective sewer pipe item.

9.03 DEFINITION OF ITEM

- A. Item 9 – Remove and Replace Catch Basin.

9.04 MEASUREMENT & PAYMENT

- A. The quantity to be paid under Item 9 shall be the full compensation for each catch basin removed and replaced, furnished and installed in accordance with the Specifications and Drawings. A catch basin removed and replaced includes 3-feet of pipe for each connection.

**ITEM 10
SEWER PIPE REPAIR**

10.01 DESCRIPTION

- A. Under these Items, the Contractor shall furnish and perform all work necessary for the installation of the sewer pipe as scheduled, shown on the Drawings and specified, in conformance with relevant sections of the Specifications.
- B. These Items shall include all work to install the sewers, including but not limited to the following: excavation; hauling excess spoil material from project site; backfill; compaction; bedding; pipe materials; fittings; maintenance of trenches; temporary pavement; connections to existing sewers; and related work such as performing material testing; deflection and infiltration tests.
- C. Connections of new sewers to existing sewers shall be included under these Items, unless specifically included under other Items.
- D. Maintaining existing sewers in operation and temporary flow stoppage, diversions and sewer flow by-pass connections shall be included under these Items.
- E. Restoration of landscape surface improvements including seeding, mulching, and fertilizing all disturbed lawn areas shall be included under these Items, unless specifically included under other Items.
- F. The furnishing and placing of special backfill in areas excavated for this work included under these Items.
- G. All repairs of existing utilities damaged, as a result of construction, are included under these Items. The repair of drainage pipes crossing the proposed pipes shall be considered incidental to these Items and is not specifically intended to be paid by these Items.

- H. Vertical pipe sections and riser pipes for 6-inch lateral sewers and cleanouts shall be included under these Items.

10.02 WORK NOT INCLUDED

- A. Pavement replacement within the Contract limits is included under other Items.
- B. Sewers installed to convey sewage around or through the work during construction will not be measured for payment.
- C. Damage to existing utilities shall be the responsibility of the Contractor.

10.03 DEFINITION OF ITEMS

- A. Item 10a – Sewer Repair (Less than or equal to 10-inch diameter).
- B. Item 10b – Sewer Repair (12-inch diameter to 18-inch diameter).
- C. Item 10c – Sewer Repair (21-inch diameter and larger).
- D. Item 10d – New Cleanout on Lateral (Non-Paved Area).

10.04 MEASUREMENT & PAYMENT

- A. The quantities to be paid for under Items 10a, 10b, and 10c shall be the horizontal length in linear feet of pipe measured parallel to the axis of the line along the surface of the ground, provided in accordance with the Specifications and Drawings, with no deduction for laying length of fittings for the specified sizes and trench detail. The depth of the pipe shall be the average depth below the original ground surface of the pipe along a section between manholes.
- B. The quantity to be measured for payment under Item 10d shall be measured by each cleanout replaced in locations as directed by the Owner or Engineer.

**ITEM 11
VIDEO RECORDING**

11.01 DESCRIPTION

- A. Under this Item, the Contractor shall produce and deliver to the Owner, color video recordings of existing topography within the zone of influence along all pipeline routes and video recordings of designated buildings and dwellings as specified and directed.

11.02 WORK NOT INCLUDED

Not used.

11.03 DEFINITION OF ITEM

- A. Item 11 – Video Recording of the Zone of Influence.

11.04 MEASUREMENT & PAYMENT

- A. The quantity to be paid for under Item 11 shall be a lump sum for video recording of the defined zone of influence along specified routes as provided in accordance with the Specifications and Drawings.

**ITEM 12
CCTV INSPECTION OF SEWERS**

12.01 DESCRIPTION

- A. Under this Item, the Contractor shall perform pre- and post- closed circuit television inspections of sewers within close proximity to the new water mains being installed via drilling methods or sewers being crossed by new water mains being installed via drilling as part of the work, as specified herein.
- B. The preparation and submittal of video records and submission to the Owner and Engineer shall be included under this Item.

12.02 WORK NOT INCLUDED

- A. Video Recording of the Zone of Influence is included under other Items.

12.03 DEFINITION OF ITEMS

- A. Item 12 – CCTV Inspections of Sewers.

12.04 MEASUREMENT & PAYMENT

- A. The quantity to be paid for under Item 12 shall be full compensation for each linear foot inspected as measured.

**ITEM 13
MAINTENANCE OF TRAFFIC**

13.01 DESCRIPTION

- A. This Item shall include the furnishing and maintaining of measures required to maintain traffic through or around the proposed Work.
- B. This Item shall include detour routes as specified in the Contract Documents.

13.02 WORK NOT INCLUDED

Not used.

13.03 DEFINITION OF ITEM

A. Item 13 – Maintenance of Traffic.

13.04 MEASUREMENT & PAYMENT

A. The quantity to be paid for under Item 13 shall be lump sum for all maintenance of traffic measures provided in accordance with the Specifications and Drawings.

**ITEM 14
STORM WATER POLLUTION PREVENTION**

14.01 DESCRIPTION

- A. This Item shall include all Work specified in the SWPPP including preparation of a Storm Water Pollution Prevention Plan, installation, maintenance, and removal of all Storm Water Pollution Prevention measures.
- B. The weekly inspection and reporting of all Storm Water Pollution Prevention measures shall be included under this Item.
- C. Obtaining permits and co-permittee coverage specified shall be included under this Item.

14.02 WORK NOT INCLUDED

Not used.

14.03 DEFINITION OF ITEM

A. Item 14 – Storm Water Pollution Prevention.

14.04 MEASUREMENT & PAYMENT

- A. The lump sum stated in the Bid shall be full compensation for all Work required under Item 14 provided in accordance with the Specifications and Drawings.
- B. Payment shall be made in the amount of 20% of the lump sum Bid price for Item 14 for the first monthly estimate and 5% for each monthly estimate thereafter until the lump sum Bid amount for Item 14 has been paid.
- C. The Engineer may reduce the amount to be paid under Item 14 if the percentage requested is not represented by the actual amount performed.

**ITEM 15
CLEARING AND GRUBBING**

15.01 DESCRIPTION

- A. This Item shall include all clearing and grubbing of lands required to complete the work as specified, shown in the Contract Documents and as directed by the Engineer.
- B. This work shall include, but not limited to, the complete removal of all vegetation including plants, shrubs, sod, agricultural crop residue, trimming and cutting of trees, removal of tree cuttings and stumps, scalping and the removal and disposal of all debris generated by the clearing and grubbing operation as specified and shown on the Drawings.
- C. This work shall include any incidental trimming or pruning of trees, foliage or other vegetation needed to complete the work. The removal of generated cuttings shall also be included in this Item.

15.02 WORK NOT INCLUDED

Not used.

15.03 DEFINITION OF ITEM

- A. Item 15 – Clearing and Grubbing.

15.04 MEASUREMENT & PAYMENT

- A. The lump sum stated in the Bid shall be full compensation for all Work required under Item 15 provided in accordance with the Specifications and Drawings.
- B. Payment shall be made in the amount of a percent of the lump sum Bid price for Item 15 consistent with the percentage of work completed.

**ITEM 16
EAST BROADWAY BLOW-OFF MANHOLE ACCESS**

16.01 DESCRIPTION

- A. This Item shall include all tree removal, clearing and grubbing of lands required to complete the work as specified, shown in the Contract Documents and as directed by the Engineer.
- B. This work shall include, but not limited to, the complete removal of all vegetation including plants, shrubs, sod, agricultural crop residue, trimming and cutting of trees, removal of tree cuttings and stumps, scalping, removal of trees and the removal and disposal of all debris generated by the clearing and grubbing operation as specified and

shown in the Contract Documents for access to the blow-off manhole located west of East Broadway Street.

16.02 WORK NOT INCLUDED

- A. All clearing and grubbing, tree removal, and landscape restoration not associated with gaining access to the East Broadway blow-off manhole as specified and shown in the Contract Documents.

16.03 DEFINITION OF ITEM

- A. Item 16 – East Broadway Blow-off Manhole Access.

16.04 MEASUREMENT & PAYMENT

- C. The lump sum stated in the Bid shall be full compensation for all Work required under Item 16 provided in accordance with the Specifications.
- D. Payment shall be made in the amount of a percent of the lump sum Bid price for Item 16 consistent with the percentage of work completed.

**ITEM 17
STRUCTURE OBSTRUCTIONS**

17.01 DESCRIPTION

- A. Under these Items, the Contractor shall remove, furnish, and install the structures obstructing the proposed utility alignments as shown on the Drawings and specified in conformance with relevant Sections of Specifications.
- B. These Items shall include all the materials, equipment, labor, and supervision necessary for the removal and replacement of obstructing structures as shown on the Drawings and to replace structures damaged during construction in accordance with the Contract Documents.
- C. The disposal of existing bedding, backfill or other debris generated by work performed under these Items is included in these Items.
- D. The furnishing and placing of special backfill in areas specified under Section 02200 is included under these Items.

17.02 WORK NOT INCLUDED

Not used.

17.03 DEFINITION OF ITEM

- A. Item 17a – Remove and Replace Sign.

- B. Item 17b – Remove and Replace Mailbox.

17.04 MEASUREMENT & PAYMENT

- A. The quantities to be paid for under Item 17a and 17b shall be full compensation for each structure removed and replaced in accordance with the Specifications and Drawings.

**ITEM 18
WATER MAIN REMOVAL**

18.01 DESCRIPTION

- A. Under this Item, the Contractor shall remove water mains obstructing the proposed utility alignments as shown on the Drawings and specified in conformance with relevant Sections of Specifications.
- B. This Item shall include all the materials, equipment, labor, and supervision necessary for the removal of obstructing water mains as shown on the Drawings in accordance with the Contract Documents.
- C. The disposal of existing bedding, backfill or other debris generated by work performed under this Item is included in this Item.
- D. The furnishing and placing of special backfill in areas specified under Section 02200 is included under this Item.

18.02 WORK NOT INCLUDED

Not used.

18.03 DEFINITION OF ITEM

- A. Item 18 – Remove Existing Water Main.

18.04 MEASUREMENT & PAYMENT

- A. The quantity to be paid for under Item 18 shall be the horizontal length in linear feet of pipe measured parallel to the axis of the line along the surface of the ground, provided in accordance with Specifications and Drawings, with no deduction for length of fittings and valves. Vertical portions of the water main shall not be measured for payment.

ITEM 19
FENCE

19.01 DESCRIPTION

- A. Under this Item, the Contractor shall furnish and install the fencing and accessories as shown on the Drawings and specified in conformance with relevant Sections of the Specifications.
- B. This Item shall include all the materials, equipment, labor, and supervision necessary for the installation of new fencing as shown on the Drawings and to replace fencing damaged during construction in accordance with the Contract Documents.
- C. This Item shall include the fence fabric, fence posts and rails, all accessories, gates, aggregate maintenance strip, barbed wire, and concrete footings as shown on the drawings and specified in conformance with relevant Sections of the Specifications.

19.02 WORK NOT INCLUDED

Not used.

19.03 DEFINITION OF ITEMS

- A. Item 19 – Remove and Replace Fence.

19.04 MEASUREMENT & PAYMENT

- A. The quantity to be paid for under Item 19 shall be the horizontal length in linear feet of fence installed provided in accordance with the Specifications and Drawings.

END OF SECTION

TOL-814901003-COMBINED-6-1-07 GENERAL SUMMARY
 12/30/2024 9:27 AM - JHARRISON
 12/30/2024 9:54 AM

Item No.	Plan Quantity	Contingency Quantity	Grand Total	Unit	Description	W-1-1	W-1-2	W-1-3	W-1-4	W-1-5	W-1-6	W-1-2.1
1	1	0	1	LS	Mobilization and Demobilization	0	0	0	0	0	0	0
2a	32	8	40	LF	4-inch Water Main, Type B	0	0	0	0	0	0	0
2b	2	8	10	LF	4-inch Water Main, Type C	0	0	0	0	0	0	0
2c	93	7	100	LF	6-inch Water Main, Type B	0	0	0	0	0	0	0
2d	4	6	10	LF	6-inch Water Main, Type C	0	0	0	0	0	0	0
2e	5050	50	5100	LF	8-inch Water Main, Type B	0	0	0	0	5	0	12
2f	380	20	400	LF	8-inch Water Main, Type C	9	0	0	0	0	0	4
2g	86	14	100	LF	8-inch Water Main, Trenchless	0	0	0	0	0	0	0
2h	1071	13	1084	LF	10-inch Water Main, Type B	0	0	0	0	0	0	0
2i	276	14	290	LF	10-inch Water Main, Type C	0	0	0	0	0	0	0
2j	1797	13	1810	LF	12-inch Water Main, Type B	211	438	347	307	292	0	0
2k	4089	11	4100	LF	12-inch Water Main, Type C	248	115	207	251	275	538	0
2l	5244	16	5260	LF	12-inch Water Main, Trenchless	0	0	0	0	0	0	0
2m	2280	10	2290	LF	16-inch Water Main, Type B	0	0	0	0	0	0	0
2n	3211	23	3234	LF	16-inch Water Main, Type C	0	0	0	0	0	0	0
2o	212	20	232	LF	16-inch Water Main, Trenchless	0	0	0	0	0	0	0
2p	234	16	250	LF	16-inch Water Main in 30-inch Bored Casing	0	0	0	0	0	0	0
2q	5	15	20	LF	20-inch Water Main, Type B	0	0	0	0	0	0	0
2r	18	0	18	EA	Connection to Existing Water Mains 12-inch and Smaller (Without Tapping)	1	0	0	0	0	1	1
2s	6	0	6	EA	Connection to Existing Water Mains Larger than 12-inch (Without Tapping)	0	0	0	0	0	0	0
2t	38	0	38	EA	Existing Water Main Plugged	0	0	0	2	2	2	0
2u	22	0	22	EA	Water Main Termination and Abandonment	1	0	0	0	0	1	1
3a	2	0	2	EA	3-inch Gate Valve and Box	0	0	0	0	0	0	0
3b	1	0	1	EA	4-inch Gate Valve and Box	0	0	0	0	0	0	0
3c	2	0	2	EA	6-inch Gate Valve and Box	0	0	0	0	0	0	0
3d	19	0	19	EA	8-inch Gate Valve and Box	1	0	0	0	0	0	1
3e	3	0	3	EA	10-inch Gate Valve and Box	0	0	0	0	0	0	0
3f	17	0	17	EA	12-inch Gate Valve and Manhole	1	2	0	1	1	1	0
3g	6	0	6	EA	16-inch Butterfly Valve and Manhole	0	0	0	0	0	0	0
3h	1	0	1	EA	10-inch by 8-inch Tapping Sleeve, Valve and Box	0	0	0	0	0	0	0
3i	1	0	1	EA	16-inch Tapping Valve and Box	0	0	0	0	0	0	0
3j	1	0	1	EA	24-inch by 12-inch Tapping Sleeve, Valve and Box	0	0	0	0	0	0	0
3k	1	0	1	EA	Valve Box	0	0	0	0	0	0	0
3l	8	0	8	EA	Valve Box Abandoned	0	0	0	0	0	0	0
3m	1	0	1	EA	Valve Box Removed	0	0	0	0	0	0	0
3n	27	0	27	EA	Valve Manhole Abandoned	1	2	0	1	1	0	1
3o	8	0	8	EA	Valve Manhole Removed	1	0	0	0	0	2	0
4a	29	0	29	EA	Fire Hydrant Assembly, Type A	1	1	1	2	0	0	0
4b	38	0	38	EA	Fire Hydrant Assembly, Type B	1	0	0	0	1	0	0
4c	1	0	1	EA	Fire Hydrant Assembly, Type C	0	0	0	0	0	0	0
4d	5	0	5	EA	Fire Hydrant Assembly, Type SC	0	0	0	0	0	0	0
4e	46	0	46	EA	Fire Hydrant Assembly Removed	2	1	1	2	1	0	0
5a	1626	75	1701	LF	Water Service (Less than 2-inch diameter)	20	26	42	71	7	0	0
5b	13	7	20	LF	Water Service (2-inch diameter and greater)	0	0	0	0	0	0	0
5c	3602	290	3892	LF	Trenchless Water Service (Less than 2-inch diameter)	89	90	317	296	110	0	0
5d	175	5	180	EA	Water Service Connection Reinstated (Less than 2-inch diameter)	4	4	10	13	4	0	0
5e	3	1	4	EA	Water Service Connection Reinstated (2-inch diameter and greater)	0	0	0	0	0	0	0
5f	173	4	177	EA	Water Meter Pit Installation	4	4	10	13	4	0	0
6a	5759	20	5779	SY	Flexible Pavement Trench Repair - Heavy Roadway	99	300	196	103	5	0	0
6b	262	20	282	SY	Flexible Pavement Trench Repair - Residential Roadway	0	0	0	0	0	0	0
6c	438	16	454	SY	Flexible Pavement Trench Repair - Driveway	0	0	29	0	0	0	0
6d	6459	20	6479	SY	Temporary Pavement Repair	99	300	225	103	5	0	0
6e	253	20	273	SY	ODOT Item 411 Stabilized Crushed Aggregate (Berm and Drive)	60	0	11	47	48	0	0
6f	4956	20	4976	SY	Flexible Pavement Planing and Resurfacing	0	0	0	0	0	0	0
6f-alt	7685	20	7705	SY	Flexible Pavement Planing and Resurfacing	0	0	0	0	0	0	0
7a	449	17	466	SY	6-inch ODOT Item 452 Non-Reinforced Concrete Pavement, Class MS (Residential Drive Approach)	0	39	0	123	20	0	0
7b	8488	20	8508	SF	4-inch Concrete Sidewalk	0	0	0	17	0	0	0
7c	337	16	353	SF	6-inch Concrete Sidewalk and Curb Ramp with Detectable Warning Surface	0	0	0	0	0	0	0
8a	21	9	30	LF	Concrete Curb	0	0	0	0	0	0	0
8b	222	9	231	LF	Concrete Curb and Gutter	0	0	0	0	0	0	0
9	0	11	11	EA	Remove and Replace Catch Basin	0	0	0	0	0	0	0
10a	110	10	120	LF	Sewer Repair (Less than or equal to 10-inch diameter)	5	0	0	5	0	0	0
10b	104	16	120	LF	Sewer Repair (12-inch diameter to 18-inch diameter)	0	0	5	0	0	0	5
10c	35	20	55	LF	Sewer Repair (21-inch diameter and larger)	0	0	0	0	0	0	0
10d	1	0	1	EA	New Cleanout on Lateral (Non-Paved Area)	0	0	0	1	0	0	0
11	1	0	1	LS	Video Recording of the Zone of Influence	0	0	0	0	0	0	0
12	1202	200	1402	LF	CCTV Inspections of Sewers	0	0	0	0	0	0	0
13	1	0	1	LS	Maintenance of Traffic	0	0	0	0	0	0	0
14	1	0	1	LS	Storm Water Pollution Prevention	0	0	0	0	0	0	0
15	1	0	1	LS	Clearing and Grubbing	0	0	0	0	0	0	0
16	1	0	1	LS	East Broadway Blow-off Manhole Access	0	0	0	0	0	0	0
17a	3	7	10	EA	Remove and Replace Sign	0	0	0	0	0	0	0
17b	14	6	20	EA	Remove and Replace Mailbox	0	3	8	2	0	0	0
18	217	12	229	LF	Remove Existing Water Main	27	0	0	0	0	22	4
19	362	8	370	EA	Remove and Replace Fence	0	0	0	0	274	88	0
Allowance	1	0	1	LS	Utility Pole Holding	0	0	0	0	0	0	0
Allowance	1	0	1	LS	Railroad Liability Insurance	0	0	0	0	0	0	0

PAY ITEMS AND GRAND TOTAL QUANTITIES LISTED REPRESENT THE TOTAL FOR THE ENTIRE PROJECT. FOR DETAILED QUANTITIES SPECIFIC TO EACH SUBPROJECT, CONTRACTOR SHALL REFER TO SHEET SPECIFIC QUANTITIES SHOWN ON EACH SUBPROJECT'S GENERAL SUMMARY SHEET.

QUANTITY NOTES:

- QUANTITIES SHOWN IN THE GENERAL SUMMARY ARE REFERENCED TO THE WATER LINE PLAN AND PROFILE SHEETS.
- BIDDERS/CONTRACTORS SHALL CALL DISCREPANCIES TO THE ENGINEERS ATTENTION AS SOON AS THEY ARE DISCOVERED.
- BIDDER ACKNOWLEDGES THAT QUANTITIES ARE NOT GUARANTEED AND FINAL PAYMENT WILL BE BASED ON ACTUAL QUANTITIES DETERMINED AS PROVIDED IN THE CONTRACT DOCUMENTS.
- SURFACE REPAIR QUANTITIES ARE LISTED ON THEIR RESPECTIVE WATER MAIN PLAN AND PROFILE SHEET.

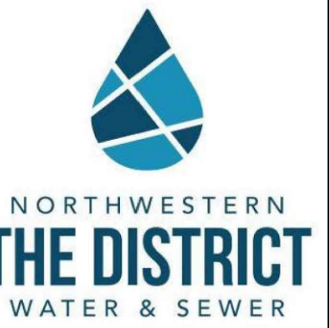

GENERAL SUMMARY
 NORTHWESTERN WATER & SEWER DISTRICT, OHIO
 2025 NWS 100 AREA WATERLINE IMPROVEMENTS WL-100E

EAF BY
 EAF
 EAF
 REVISIONS AFTER ISSUED FOR BID
 NO. DATE
 1 12/30/24 ADDENDUM 5
 2 12/30/24 ADDENDUM 5
 3
 4
 5

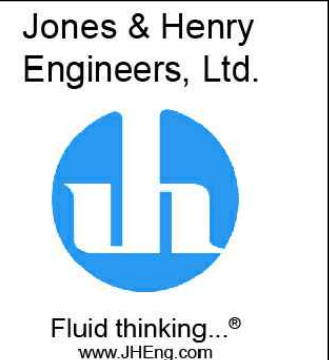

JOB NO. 796-8149.001
 SCALE NONE
 THIS LINE SCALES IF WHEN PLOTTED TO NOTED SCALE
 DESIGNED EAF DRAWN DJK CHECKED TAB
 STATUS: ISSUED FOR BID
 DATE: NOVEMBER 2024
 SHEET NO.
G-1-0.7
 7 OF 116

Table with columns: Item No., Plan Quantity, Contingency Quantity, Grand Total, Unit, Description, and 21 quantity columns (W-2-1.1 to W-2-2.1). Rows include various construction items like Mobilization and Demobilization, Water Main installation, Gate Valves, Fire Hydrants, Pavement Repair, and Sewer Repair.

PAY ITEMS AND GRAND TOTAL QUANTITIES LISTED REPRESENT THE TOTAL FOR THE ENTIRE PROJECT. FOR DETAILED QUANTITIES SPECIFIC TO EACH SUBPROJECT, CONTRACTOR SHALL REFER TO SHEET SPECIFIC QUANTITIES SHOWN ON EACH SUBPROJECT'S GENERAL SUMMARY SHEET.

- QUANTITY NOTES:
1. QUANTITIES SHOWN IN THE GENERAL SUMMARY ARE REFERENCED TO THE WATER LINE PLAN AND PROFILE SHEETS.
2. BIDDERS/CONTRACTORS SHALL CALL DISCREPANCIES TO THE ENGINEERS ATTENTION AS SOON AS THEY ARE DISCOVERED.
3. BIDDER ACKNOWLEDGES THAT QUANTITIES ARE NOT GUARANTEED AND FINAL PAYMENT WILL BE BASED ON ACTUAL QUANTITIES DETERMINED AS PROVIDED IN THE CONTRACT DOCUMENTS.
4. SURFACE REPAIR QUANTITIES ARE LISTED ON THEIR RESPECTIVE WATER MAIN PLAN AND PROFILE SHEET.

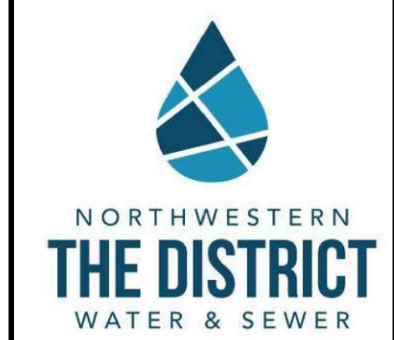

GENERAL SUMMARY
NORTHWESTERN WATER & SEWER DISTRICT, OHIO
2025 NWSD 100 AREA WATERLINE IMPROVEMENTS WL-100E

Revision table with columns: No., Date, and Description. It tracks revisions made during the design process.

Logo for Jones & Henry Engineers, Ltd. with the text 'Fluid thinking... www.JHEng.com'.

Job information section containing: JOB NO: 796-8149.001, SCALE: NONE, ISSUED FOR BID DATE: NOVEMBER 2024, SHEET NO: G-2-0.8, and 8 OF 116.

TOL-814901001-COMBINED-5-4-0-10 GENERAL SUMMARY
12/30/2024 9:27 AM - JHARRISON
12/30/2024 9:54 AM

Item No.	Plan Quantity	Contingency Quantity	Grand Total	Unit	Description	W-4-1.1	W-4-1.2	W-4-1.3	W-4-1.4	W-4-1.5	W-4-2.1	W-4-2.2	W-4-2.3	W-4-3.1	W-4-4.1	W-4-4.2	W-4-5.1
1	1	0	1	LS	Mobilization and Demobilization	0	0	0	0	0	0	0	0	0	0	0	0
2a	32	8	40	LF	4-inch Water Main, Type B	0	0	0	0	0	0	0	0	0	0	0	0
2b	2	8	10	LF	4-inch Water Main, Type C	0	0	0	0	0	0	0	0	0	0	0	0
2c	93	7	100	LF	6-inch Water Main, Type B	0	0	0	0	0	0	0	0	0	0	0	0
2d	4	6	10	LF	6-inch Water Main, Type C	0	0	0	0	0	0	0	0	0	0	0	0
2e	5050	50	5100	LF	8-inch Water Main, Type B	0	0	0	0	0	0	0	0	0	22	0	33
2f	380	20	400	LF	8-inch Water Main, Type C	0	0	0	0	0	0	0	0	0	26	0	16
2g	86	14	100	LF	8-inch Water Main, Trenchless	0	0	0	0	0	0	0	0	0	0	0	0
2h	1071	13	1084	LF	10-inch Water Main, Type B	0	0	0	0	0	220	550	301	0	0	0	0
2i	276	14	290	LF	10-inch Water Main, Type C	0	0	0	0	0	276	0	0	0	0	0	0
2j	1797	13	1810	LF	12-inch Water Main, Type B	3	0	0	0	0	0	0	0	0	0	0	0
2k	4089	11	4100	LF	12-inch Water Main, Type C	0	0	0	0	0	0	0	0	0	0	0	0
2l	5244	16	5260	LF	12-inch Water Main, Trenchless	0	0	0	0	0	0	0	0	0	0	0	0
2m	2280	10	2290	LF	16-inch Water Main, Type B	446	550	550	550	64	0	0	0	18	0	0	0
2n	3211	23	3234	LF	16-inch Water Main, Type C	0	0	0	0	0	0	0	0	0	0	0	0
2o	212	20	232	LF	16-inch Water Main, Trenchless	0	0	0	0	0	0	0	0	0	0	0	0
2p	234	16	250	LF	16-inch Water Main in 30-inch Bored Casing	0	0	0	0	0	0	0	0	0	0	0	0
2q	5	15	20	LF	20-inch Water Main, Type B	0	0	0	0	0	0	0	0	0	0	0	0
2r	18	0	18	EA	Connection to Existing Water Mains 12-inch and Smaller (Without Tapping)	1	0	0	0	0	0	0	0	0	1	0	1
2s	6	0	6	EA	Connection to Existing Water Mains Larger than 12-inch (Without Tapping)	0	0	0	0	1	0	0	0	1	0	0	0
2t	38	0	38	EA	Existing Water Main Plugged	1	0	2	0	0	0	2	0	1	0	1	0
2u	22	0	22	EA	Water Main Termination and Abandonment	1	0	0	0	1	0	0	0	1	1	0	1
3a	2	0	2	EA	3-inch Gate Valve and Box	0	0	0	0	0	0	0	0	0	0	0	0
3b	1	0	1	EA	4-inch Gate Valve and Box	0	0	0	0	0	0	0	0	0	0	0	0
3c	2	0	2	EA	6-inch Gate Valve and Box	0	0	0	0	0	0	0	0	0	0	0	0
3d	19	0	19	EA	8-inch Gate Valve and Box	0	0	0	0	0	0	0	0	0	1	0	1
3e	3	0	3	EA	10-inch Gate Valve and Box	0	0	0	0	0	1	1	1	0	0	0	0
3f	17	0	17	EA	12-inch Gate Valve and Manhole	0	0	0	0	0	0	0	0	0	0	0	0
3g	6	0	6	EA	16-inch Butterfly Valve and Manhole	0	1	1	0	1	0	0	0	1	0	0	0
3h	1	0	1	EA	10-inch by 8-inch Tapping Sleeve, Valve and Box	0	0	0	0	0	0	0	0	0	0	0	0
3i	1	0	1	EA	16-inch Tapping Valve and Box	0	0	0	0	0	0	0	0	0	0	0	0
3j	1	0	1	EA	24-inch by 12-inch Tapping Sleeve, Valve and Box	0	0	0	0	0	0	0	0	0	0	0	0
3k	1	0	1	EA	Valve Box	0	0	0	0	0	0	0	0	0	0	0	0
3l	8	0	8	EA	Valve Box Abandoned	0	0	0	0	0	0	0	0	0	0	0	0
3m	1	0	1	EA	Valve Box Removed	0	0	0	0	0	0	0	0	0	0	0	0
3n	27	0	27	EA	Valve Manhole Abandoned	0	1	1	0	0	1	0	0	0	1	1	0
3o	8	0	8	EA	Valve Manhole Removed	0	0	0	0	1	0	0	0	1	0	0	1
4a	29	0	29	EA	Fire Hydrant Assembly, Type A	1	2	2	2	1	0	2	1	0	0	0	0
4b	38	0	38	EA	Fire Hydrant Assembly, Type B	0	0	0	0	0	2	0	0	0	0	0	0
4c	1	0	1	EA	Fire Hydrant Assembly, Type C	0	0	0	0	0	0	0	1	0	0	0	0
4d	5	0	5	EA	Fire Hydrant Assembly, Type SC	0	0	0	0	0	0	0	0	0	0	0	0
4e	46	0	46	EA	Fire Hydrant Assembly Removed	1	2	2	1	1	1	2	2	0	0	0	0
5a	1626	75	1701	LF	Water Service (Less than 2-inch diameter)	32	135	35	29	0	27	21	21	0	0	325	0
5b	13	7	20	LF	Water Service (2-inch diameter and greater)	0	0	0	0	0	0	0	0	0	0	0	0
5c	3602	290	3892	LF	Trenchless Water Service (Less than 2-inch diameter)	0	0	0	43	0	90	37	60	0	0	0	0
5d	175	5	180	EA	Water Service Connection Reinstated (Less than 2-inch diameter)	1	5	2	3	0	4	2	2	0	0	3	0
5e	3	1	4	EA	Water Service Connection Reinstated (2-inch diameter and greater)	0	0	0	0	0	0	0	0	0	0	0	0
5f	173	4	177	EA	Water Meter Pit Installation	1	5	2	3	0	4	2	2	0	0	3	0
6a	5759	20	5779	SY	Flexible Pavement Trench Repair - Heavy Roadway	372	474	609	564	70	94	484	252	0	0	0	0
6b	262	20	282	SY	Flexible Pavement Trench Repair - Residential Roadway	0	0	0	0	0	0	2	0	0	0	0	0
6c	438	16	454	SY	Flexible Pavement Trench Repair - Driveway	0	0	7	10	0	68	0	0	0	0	238	0
6d	6459	20	6479	SY	Temporary Pavement Repair	372	474	616	574	70	162	486	252	0	0	238	0
6e	253	20	273	SY	ODOT Item 411 Stabilized Crushed Aggregate (Berm and Drive)	0	0	0	0	0	0	0	0	0	0	0	0
6f	4956	20	4976	SY	Flexible Pavement Planing and Resurfacing	413	371	157	214	25	46	369	479	0	0	0	0
6f-alt	7685	20	7705	SY	Flexible Pavement Planing and Resurfacing	618	870	779	768	84	0	0	0	0	0	0	0
7a	449	17	466	SY	6-inch ODOT Item 452 Non-Reinforced Concrete Pavement, Class MS (Residential Drive Approach)	0	0	0	10	0	0	0	0	0	0	0	0
7b	8488	20	8508	SF	4-inch Concrete Sidewalk	0	0	0	0	0	0	0	0	0	0	0	0
7c	337	16	353	SF	6-inch Concrete Sidewalk and Curb Ramp with Detectable Warning Surface	0	0	0	0	0	0	0	0	0	0	0	0
8a	21	9	30	LF	Concrete Curb	0	0	0	0	0	0	0	0	0	0	0	0
8b	222	9	231	LF	Concrete Curb and Gutter	0	32	0	0	0	18	43	18	0	0	0	0
9	0	11	11	EA	Remove and Replace Catch Basin	0	0	0	0	0	0	0	0	0	0	0	0
10a	110	10	120	LF	Sewer Repair (Less than or equal to 10-inch diameter)	5	0	0	0	0	0	0	10	0	0	0	0
10b	104	16	120	LF	Sewer Repair (12-inch diameter to 18-inch diameter)	0	5	15	0	5	5	0	0	0	0	0	0
10c	35	20	55	LF	Sewer Repair (21-inch diameter and larger)	0	0	0	0	0	0	0	0	0	0	0	5
10d	1	0	1	EA	New Cleanout on Lateral (Non-Paved Area)	0	0	0	0	0	0	0	0	0	0	0	0
11	1	0	1	LS	Video Recording of the Zone of Influence	0	0	0	0	0	0	0	0	0	0	0	0
12	1202	200	1402	LF	CCTV Inspections of Sewers	0	0	0	0	0	0	0	0	0	0	0	0
13	1	0	1	LS	Maintenance of Traffic	0	0	0	0	0	0	0	0	0	0	0	0
14	1	0	1	LS	Storm Water Pollution Prevention	0	0	0	0	0	0	0	0	0	0	0	0
15	1	0	1	LS	Clearing and Grubbing	0	0	0	0	0	0	0	0	0	0	0	0
16	1	0	1	LS	East Broadway Blow-off Manhole Access	0	0	0	0	0	0	0	0	0	0	0	0
17a	3	7	10	EA	Remove and Replace Sign	0	0	0	0	0	0	0	0	0	0	0	0
17b	14	6	20	EA	Remove and Replace Mailbox	0	0	0	0	0	0	0	1	0	0	0	0
18	217	12	229	LF	Remove Existing Water Main	16	0	0	0	20	0	12	0	10	0	0	0
19	362	8	370	EA	Remove and Replace Fence	0	0	0	0	0	0	0	0	0	0	0	0
Allowance	1	0	1	LS	Utility Pole Holding	0	0	0	0	0	0	0	0	0	0	0	0
Allowance	1	0	1	LS	Railroad Liability Insurance	0	0	0	0	0	0	0	0	0	0	0	0

PAY ITEMS AND GRAND TOTAL QUANTITIES LISTED REPRESENT THE TOTAL FOR THE ENTIRE PROJECT. FOR DETAILED QUANTITIES SPECIFIC TO EACH SUBPROJECT, CONTRACTOR SHALL REFER TO SHEET SPECIFIC QUANTITIES SHOWN ON EACH SUBPROJECT'S GENERAL SUMMARY SHEET.

QUANTITY NOTES:

- QUANTITIES SHOWN IN THE GENERAL SUMMARY ARE REFERENCED TO THE WATER LINE PLAN AND PROFILE SHEETS.
- BIDDERS/CONTRACTORS SHALL CALL DISCREPANCIES TO THE ENGINEERS ATTENTION AS SOON AS THEY ARE DISCOVERED.
- BIDDER ACKNOWLEDGES THAT QUANTITIES ARE NOT GUARANTEED AND FINAL PAYMENT WILL BE BASED ON ACTUAL QUANTITIES DETERMINED AS PROVIDED IN THE CONTRACT DOCUMENTS.
- SURFACE REPAIR QUANTITIES ARE LISTED ON THEIR RESPECTIVE WATER MAIN PLAN AND PROFILE SHEET.

3

3

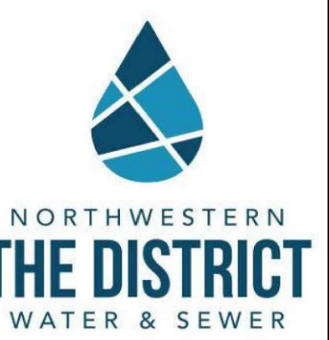

NORTHWESTERN WATER & SEWER DISTRICT, OHIO

2025 NWS 100 AREA WATERLINE IMPROVEMENTS WL-100E

GENERAL SUMMARY

DESIGNED	EAJ	DATE	12/30/24
DRAWN	DJK	DATE	12/30/24
CHECKED	TAB	DATE	12/30/24
STATUS	ISSUED FOR BID		
DATE	NOVEMBER 2024		

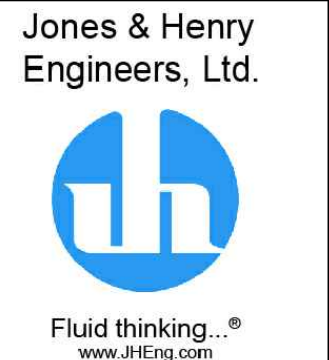

JOB NO. 796-8149.001

SCALE NONE

THIS LINE SCALES IF WHEN PLOTTED TO NOTED SCALE

NO. 10 OF 116

G-4-0.10

TOL-8149001003-COMBINED-4-5-0-11 GENERAL SUMMARY
 12/30/2024 9:27 AM - JHARRISON
 12/30/2024 9:54 AM

Item No.	Plan Quantity	Contingency Quantity	Grand Total	Unit	Description	W-5-1.1	W-5-1.2	W-5-1.3	W-5-1.4	W-5-1.5	W-5-1.6	W-5-1.7
1	1	0	1	LS	Mobilization and Demobilization	0	0	0	0	0	0	0
2a	32	8	40	LF	4-inch Water Main, Type B	0	0	0	0	0	0	0
2b	2	8	10	LF	4-inch Water Main, Type C	0	0	0	0	0	0	0
2c	93	7	100	LF	6-inch Water Main, Type B	0	0	0	0	0	0	0
2d	4	6	10	LF	6-inch Water Main, Type C	0	0	0	0	0	0	0
2e	5050	50	5100	LF	8-inch Water Main, Type B	0	0	0	0	0	0	0
2f	380	20	400	LF	8-inch Water Main, Type C	0	0	0	0	0	0	0
2g	86	14	100	LF	8-inch Water Main, Trenchless	0	0	0	0	0	0	0
2h	1071	13	1084	LF	10-inch Water Main, Type B	0	0	0	0	0	0	0
2i	276	14	290	LF	10-inch Water Main, Type C	0	0	0	0	0	0	0
2j	1797	13	1810	LF	12-inch Water Main, Type B	0	0	0	0	0	0	0
2k	4089	11	4100	LF	12-inch Water Main, Type C	0	0	0	0	0	0	0
2l	5244	16	5260	LF	12-inch Water Main, Trenchless	0	0	0	0	0	0	0
2m	2280	10	2290	LF	16-inch Water Main, Type B	0	44	0	0	0	35	6
2n	3211	23	3234	LF	16-inch Water Main, Type C	436	287	533	550	550	515	340
2o	212	20	232	LF	16-inch Water Main, Trenchless	0	0	0	0	0	0	212
2p	234	16	250	LF	16-inch Water Main in 30-inch Bored Casing	3	231	0	0	0	0	0
2q	5	15	20	EA	20-inch Water Main, Type B	0	0	0	0	0	0	0
2r	18	0	18	EA	Connection to Existing Water Mains 12-inch and Smaller (Without Tapping)	0	0	0	0	0	0	0
2s	6	0	6	EA	Connection to Existing Water Mains Larger than 12-inch (Without Tapping)	1	0	0	0	0	0	1
2t	38	0	38	EA	Existing Water Main Plugged	0	0	0	0	0	0	0
2u	22	0	22	EA	Water Main Termination and Abandonment	0	0	0	0	0	0	0
3a	2	0	2	EA	3-inch Gate Valve and Box	0	0	0	0	0	0	0
3b	1	0	1	EA	4-inch Gate Valve and Box	0	0	0	0	0	0	0
3c	2	0	2	EA	6-inch Gate Valve and Box	0	0	0	0	0	0	0
3d	19	0	19	EA	8-inch Gate Valve and Box	0	0	0	0	0	0	0
3e	3	0	3	EA	10-inch Gate Valve and Box	0	0	0	0	0	0	0
3f	17	0	17	EA	12-inch Gate Valve and Manhole	0	0	0	0	0	0	0
3g	6	0	6	EA	16-inch Butterfly Valve and Manhole	0	1	0	0	1	0	0
3h	1	0	1	EA	10-inch by 8-inch Tapping Sleeve, Valve and Box	0	0	0	0	0	0	0
3i	1	0	1	EA	16-inch Tapping Valve and Box	0	0	0	0	0	0	1
3j	1	0	1	EA	24-inch by 12-inch Tapping Sleeve, Valve and Box	0	0	0	0	0	0	0
3k	1	0	1	EA	Valve Box	0	0	0	0	0	0	0
3l	8	0	8	EA	Valve Box Abandoned	0	0	0	0	0	0	0
3m	1	0	1	EA	Valve Box Removed	0	0	0	0	0	0	0
3n	27	0	27	EA	Valve Manhole Abandoned	0	0	0	0	0	0	0
3o	8	0	8	EA	Valve Manhole Removed	0	0	0	0	0	0	0
4a	29	0	29	EA	Fire Hydrant Assembly, Type A	1	1	0	0	0	0	1
4b	38	0	38	EA	Fire Hydrant Assembly, Type B	0	0	0	1	1	0	1
4c	1	0	1	EA	Fire Hydrant Assembly, Type C	0	0	0	0	0	0	0
4d	5	0	5	EA	Fire Hydrant Assembly, Type SC	0	0	0	0	0	0	0
4e	46	0	46	EA	Fire Hydrant Assembly Removed	0	0	0	0	0	0	0
5a	1626	75	1701	LF	Water Service (Less than 2-inch diameter)	0	0	0	0	0	0	0
5b	13	7	20	LF	Water Service (2-inch diameter and greater)	0	0	0	0	0	0	0
5c	3602	290	3892	LF	Trenchless Water Service (Less than 2-inch diameter)	0	0	0	0	0	0	0
5d	175	5	180	EA	Water Service Connection Reinstated (Less than 2-inch diameter)	0	0	0	0	0	0	0
5e	3	1	4	EA	Water Service Connection Reinstated (2-inch diameter and greater)	0	0	0	0	0	0	0
5f	173	4	177	EA	Water Meter Pit Installation	0	0	0	0	0	0	0
6a	5759	20	5779	SY	Flexible Pavement Trench Repair - Heavy Roadway	19	22	0	0	0	0	11
6b	262	20	282	SY	Flexible Pavement Trench Repair - Residential Roadway	0	0	0	0	0	0	0
6c	438	16	454	SY	Flexible Pavement Trench Repair - Driveway	0	0	0	0	0	0	0
6d	6459	20	6479	SY	Temporary Pavement Repair	19	22	0	0	0	0	11
6e	253	20	273	SY	ODOT Item 411 Stabilized Crushed Aggregate (Berm and Drive)	0	0	0	0	0	11	17
6f	4956	20	4976	SY	Flexible Pavement Planing and Resurfacing	0	0	0	0	0	0	0
6f-alt	7685	20	7705	SY	Flexible Pavement Planing and Resurfacing	0	0	0	0	0	0	0
7a	449	17	466	SY	6-inch ODOT Item 452 Non-Reinforced Concrete Pavement, Class MS (Residential Drive Approach)	0	0	0	0	0	0	0
7b	8488	20	8508	SF	4-inch Concrete Sidewalk	0	0	0	0	0	0	0
7c	337	16	353	SF	6-inch Concrete Sidewalk and Curb Ramp with Detectable Warning Surface	0	0	0	0	0	0	0
8a	21	9	30	LF	Concrete Curb	0	0	0	0	0	0	0
8b	222	9	231	LF	Concrete Curb and Gutter	0	0	0	0	0	0	0
9	0	11	11	EA	Remove and Replace Catch Basin	0	0	0	0	0	0	0
10a	110	10	120	LF	Sewer Repair (Less than or equal to 10-inch diameter)	0	5	0	0	0	0	0
10b	104	16	120	LF	Sewer Repair (12-inch diameter to 18-inch diameter)	5	0	0	0	0	29	5
10c	35	20	55	LF	Sewer Repair (21-inch diameter and larger)	0	0	0	0	0	10	0
10d	1	0	1	EA	New Cleanout on Lateral (Non-Paved Area)	0	0	0	0	0	0	0
11	1	0	1	LS	Video Recording of the Zone of Influence	0	0	0	0	0	0	0
12	1202	200	1402	LF	CCTV Inspections of Sewers	0	0	0	0	0	0	128
13	1	0	1	LS	Maintenance of Traffic	0	0	0	0	0	0	0
14	1	0	1	LS	Storm Water Pollution Prevention	0	0	0	0	0	0	0
15	1	0	1	LS	Clearing and Grubbing	0	0	0	0	0	0	0
16	1	0	1	LS	East Broadway Blow-off Manhole Access	0	0	0	0	0	0	0
17a	3	7	10	EA	Remove and Replace Sign	1	0	0	0	0	0	2
17b	14	6	20	EA	Remove and Replace Mailbox	0	0	0	0	0	0	0
18	217	12	229	LF	Remove Existing Water Main	0	0	0	0	0	0	0
19	362	8	370	EA	Remove and Replace Fence	0	0	0	0	0	0	0
Allowance	1	0	1	LS	Utility Pole Holding	0	0	0	0	0	0	0
Allowance	1	0	1	LS	Railroad Liability Insurance	0	0	0	0	0	0	0

PAY ITEMS AND GRAND TOTAL QUANTITIES LISTED REPRESENT THE TOTAL FOR THE ENTIRE PROJECT. FOR DETAILED QUANTITIES SPECIFIC TO EACH SUBPROJECT, CONTRACTOR SHALL REFER TO SHEET SPECIFIC QUANTITIES SHOWN ON EACH SUBPROJECT'S GENERAL SUMMARY SHEET.

QUANTITY NOTES:

- QUANTITIES SHOWN IN THE GENERAL SUMMARY ARE REFERENCED TO THE WATER LINE PLAN AND PROFILE SHEETS.
- BIDDERS/CONTRACTORS SHALL CALL DISCREPANCIES TO THE ENGINEERS ATTENTION AS SOON AS THEY ARE DISCOVERED.
- BIDDER ACKNOWLEDGES THAT QUANTITIES ARE NOT GUARANTEED AND FINAL PAYMENT WILL BE BASED ON ACTUAL QUANTITIES DETERMINED AS PROVIDED IN THE CONTRACT DOCUMENTS.
- SURFACE REPAIR QUANTITIES ARE LISTED ON THEIR RESPECTIVE WATER MAIN PLAN AND PROFILE SHEET.



GENERAL SUMMARY
 NORTHWESTERN WATER & SEWER DISTRICT, OHIO
 2025 NWS 100 AREA WATERLINE IMPROVEMENTS WL-100E

DESIGNED BY: EAF
 DRAWN BY: EAF
 CHECKED BY: EAF

REVISIONS AFTER ISSUED FOR BID
 NO. DATE



JOB NO. 796-8149.001

SCALE NONE

THIS LINE SCALES IF WHEN PLOTTED TO NOTED SCALE

DESIGNED: EAF DRAWN: DJK CHECKED: TAB

STATUS: ISSUED FOR BID
 DATE: NOVEMBER 2024

SHEET NO.
 G-5-0.11
 11 OF 116

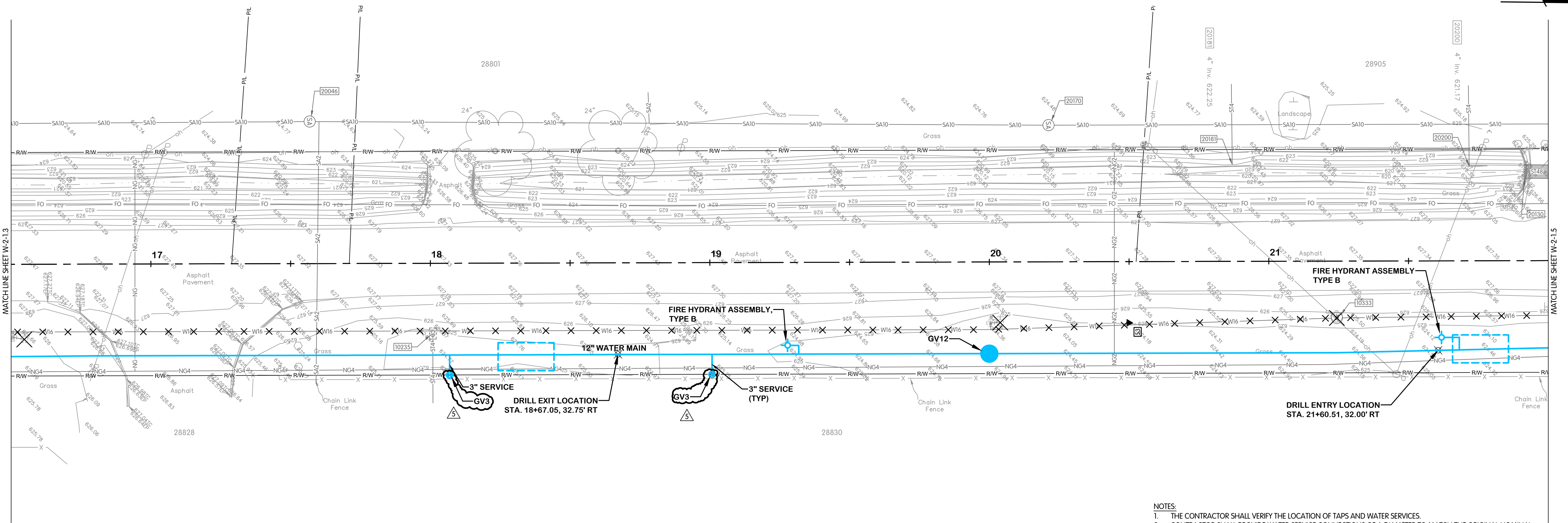

EXISTING STRUCTURE DATA			EXISTING STRUCTURE DATA		
NAME	TYPE	DATA	NAME	TYPE	DATA
10235	CATCH BASIN	CASTING EL. 624.20 4" E INV. EL. 623.30	20170	SANITARY MANHOLE	CASTING EL. 624.53 10" N INV. EL. 604.18 10" S INV. EL. 604.18
10333	WATER MANHOLE	CASTING EL. 625.15 16" N INV. EL. 618.33 16" S INV. EL. 618.33			
20046	SANITARY MANHOLE	CASTING EL. 624.85 10" N INV. EL. 604.85 10" S INV. EL. 604.85			

GLENWOOD ROAD

- NOTES:
1. THE CONTRACTOR SHALL VERIFY THE LOCATION OF TAPS AND WATER SERVICES.
 2. CONTRACTOR SHALL PROVIDE WATER SERVICE CONNECTIONS OF A DIAMETER TO MATCH THE ORIGINAL NOMINAL DIAMETER OF THE SERVICE. THE MINIMUM WATER SERVICE DIAMETER SHALL BE 1". WATER SERVICE WITH NO SIZE SHOWN SHALL BE ASSUMED TO BE 1" DIAMETER.
 3. WATER SERVICES ARE SHOWN OFFSET FROM THE EXISTING WATER SERVICES FOR CLARITY AND SHALL BE INSTALLED ALONG THE SAME ALIGNMENT.
 4. THE DISTRICT WILL SHUT DOWN THE EXISTING WATER MAIN FOR A PERIOD OF 4 HOURS TO PERMIT THE CONTRACTOR TO REMOVE SUFFICIENT LENGTH OF WATER MAIN AND CONNECT THE PROPOSED NEW WATER MAIN TO THE EXISTING WATER MAIN.
 5. LOCATIONS OF THE WATER SERVICES FOR 28828 GLENWOOD AND 28830 GLENWOOD ARE UNKNOWN. THE CONTRACTOR SHALL FIELD VERIFY THE LOCATIONS.

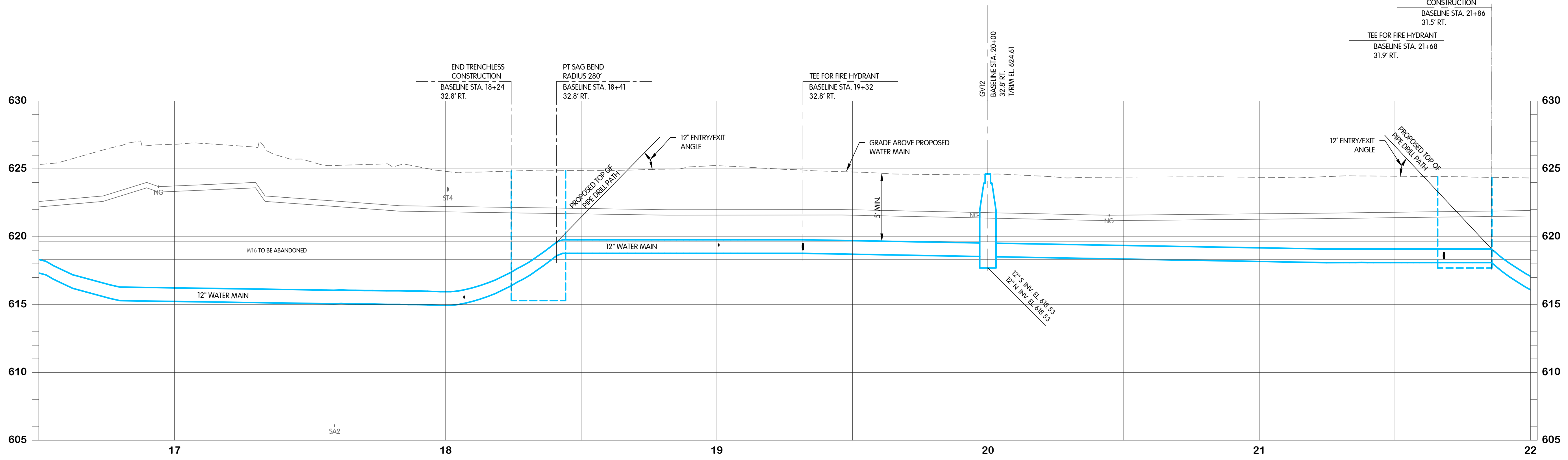

TOL-8136001-WI-COMBINED-28-W-2-1.4 GLENWOOD STA 16+50 TO 22+00
12/30/2024 9:54 AM - JHARRISON
12/30/2024 9:54 AM

NO. 1 2 3 4 5
DATE 12/30/24
ADDENDUM 5
REVISIONS AFTER ISSUED FOR BID

Jones & Henry
Engineers, Ltd.

Fluid thinking®
www.JHeng.com

JOB NO. 796-8149.001
SCALE 1"=20' HOR.
1"=4' VERT.
THIS LINE SCALES IF WHEN PLOTTED TO NOTED SCALE

DESIGNED	DRAWN	CHECKED
EAF	CAL	TAB

STATUS: ISSUED FOR BID
DATE: NOVEMBER 2024

SHEET NO.
W-2-1.4
28 OF 116

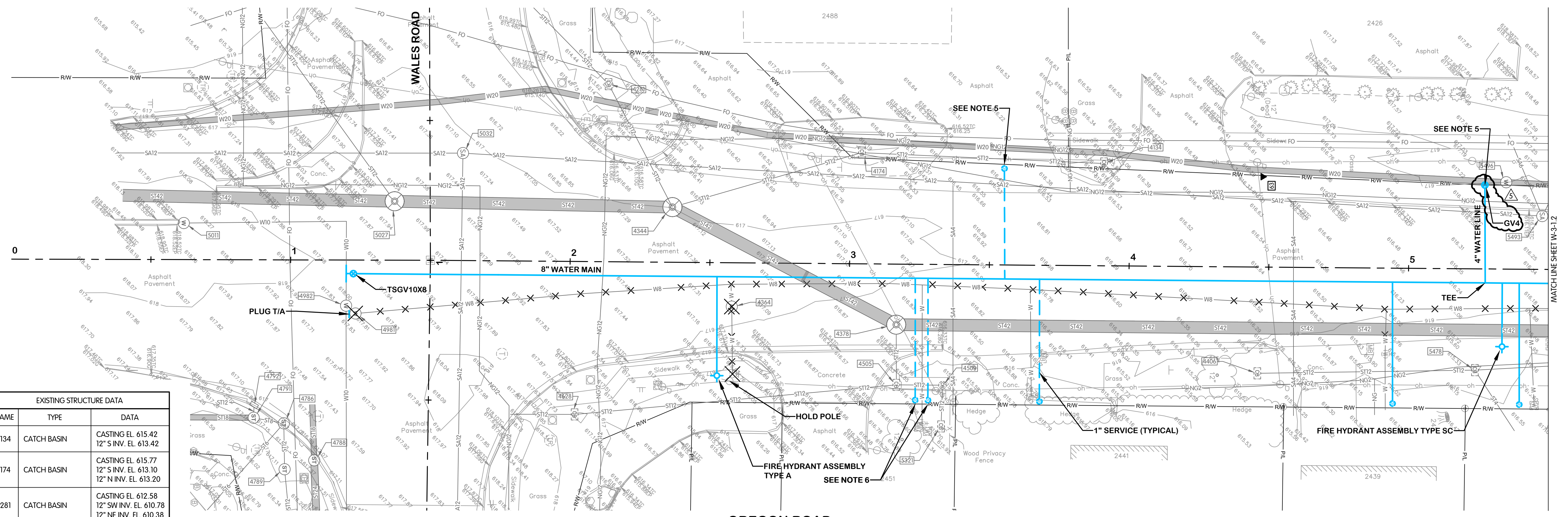

EXISTING STRUCTURE DATA		
NAME	TYPE	DATA
4134	CATCH BASIN	CASTING EL. 615.42 12" S INV. EL. 613.42
4174	CATCH BASIN	CASTING EL. 615.77 12" S INV. EL. 613.10 12" N INV. EL. 613.20
4281	CATCH BASIN	CASTING EL. 612.58 12" SW INV. EL. 610.78 12" NE INV. EL. 610.38

OREGON ROAD

EXISTING STRUCTURE DATA			EXISTING STRUCTURE DATA			EXISTING STRUCTURE DATA			EXISTING STRUCTURE DATA			EXISTING STRUCTURE DATA			EXISTING STRUCTURE DATA					
NAME	TYPE	DATA	NAME	TYPE	DATA	NAME	TYPE	DATA	NAME	TYPE	DATA	NAME	TYPE	DATA	NAME	TYPE	DATA			
4344	STORM MAHOLE 6'	CASTING EL. 616.99 42" S INV. EL. 608.69 42" NE INV. EL. 610.29	4505	CATCH BASIN	CASTING EL. 616.22 12" W INV. EL. 610.46 12" S INV. EL. 612.87 12" N INV. EL. 610.46	4786	STORM MANHOLE	CASTING EL. 616.86 8" S INV. EL. 610.76 6" SE INV. EL. 611.26 12" E INV. EL. 610.76	4791	STORM MANHOLE	CASTING EL. 617.30 18" S INV. EL. 611.50 12" W INV. EL. 612.90 8" N INV. EL. 610.50	4982	WATER MANHOLE	CASTING EL. 617.99 10" W INV. EL. 612.21 10" E INV. EL. 612.21	5032	SANITARY MANHOLE	CASTING EL. 617.17 12" N INV. EL. 604.07 12" E INV. EL. 604.17 12" S INV. EL. 604.17	5493	SANITARY MANHOLE	CASTING EL. 616.31 10" N INV. EL. 603.11 6" SW INV. EL. 603.31 10" NW INV. EL. 603.31 12" S INV. EL. 603.11
4378	STORM MAHOLE 6'	CASTING EL. 616.70 42" SW INV. EL. 608.40 42" N INV. EL. 608.30 12" E INV. EL. 610.00	4509	CATCH BASIN	CASTING EL. 615.54 12" S INV. EL. 610.44 12" E INV. EL. 610.44	4788	STORM MANHOLE	CASTING EL. 617.40 24" S INV. EL. 610.20 18" W INV. EL. 610.10	4792	CURB INLET	CASTING EL. 616.68 12" E INV. EL. 613.08	5011	WATER MANHOLE	CASTING EL. 618.48 10" N INV. EL. 612.21	5321	CATCH BASIN	CASTING EL. 615.73 12" W INV. EL. 610.03	5496	WATER MANHOLE	CASTING EL. 616.86 20" N INV. EL. 607.99 20" S INV. EL. 607.99
4406	CATCH BASIN	CASTING EL. 615.10 12" N INV. EL. 613.20	4628	CATCH BASIN	CASTING EL. 616.92 12" S INV. EL. 614.92 12" N INV. EL. 614.92	4789	STORM MANHOLE	CASTING EL. 617.43 12" S INV. EL. 611.93 12" E INV. EL. 611.93	4981	WATER MANHOLE	CASTING EL. 617.89 8" S INV. EL. 612.20 8" N INV. EL. 612.20	5027	STORM MAHOLE 6'	CASTING EL. 617.77 12" SW INV. EL. 609.17 42" S INV. EL. 609.17 42" N INV. EL. 609.17	5478	CATCH BASIN	CASTING EL. 614.92 12" N INV. EL. 612.92 12" S INV. EL. 612.92 4" NE INV. EL. 913.12			

- NOTES:
- THE CONTRACTOR SHALL VERIFY THE LOCATION OF TAPS AND WATER SERVICES.
 - THE CONTRACTOR SHALL PROVIDE WATER SERVICE CONNECTIONS OF A DIAMETER TO MATCH THE ORIGINAL NOMINAL DIAMETER OF THE SERVICE. THE MINIMUM WATER SERVICE DIAMETER SHALL BE 1" WATER SERVICE WITH NO SIZE SHOWN SHALL BE ASSUMED TO BE 1" DIAMETER.
 - WATER SERVICES ARE SHOWN OFFSET FROM THE EXISTING WATER SERVICES FOR CLARITY AND SHALL BE INSTALLED ALONG THE SAME ALIGNMENT.
 - MAILBOXES IN CONFLICT WITH THE PROPOSED WATER SERVICES OR WATER MAIN SHALL BE REMOVED AND REPLACED AS DIRECTED BY THE OWNER.
 - THE LOCATION OF THE WATER SERVICE FOR 2488 AND 2426 OREGON ROAD IS UNKNOWN. CONTRACTOR SHALL FIELD VERIFY LOCATION.
 - CONTRACTOR SHALL FIELD VERIFY NUMBER OF SERVICES AT 2451 OREGON ROAD AND REINSTATE ACCORDINGLY.
 - WATER MAINS TO BE CONSTRUCTED UNDER STORM SEWERS LARGER THAN 24" SHALL BE INSTALLED WITHOUT REMOVING THE EXISTING STORM SEWER UNLESS APPROVED BY THE ENGINEER. SUPPORT ALL PIPES IN EXCAVATIONS AS SPECIFIED. THE MEANS AND METHOD FOR THE CROSSING SHALL BE SELECTED BY THE CONTRACTOR.

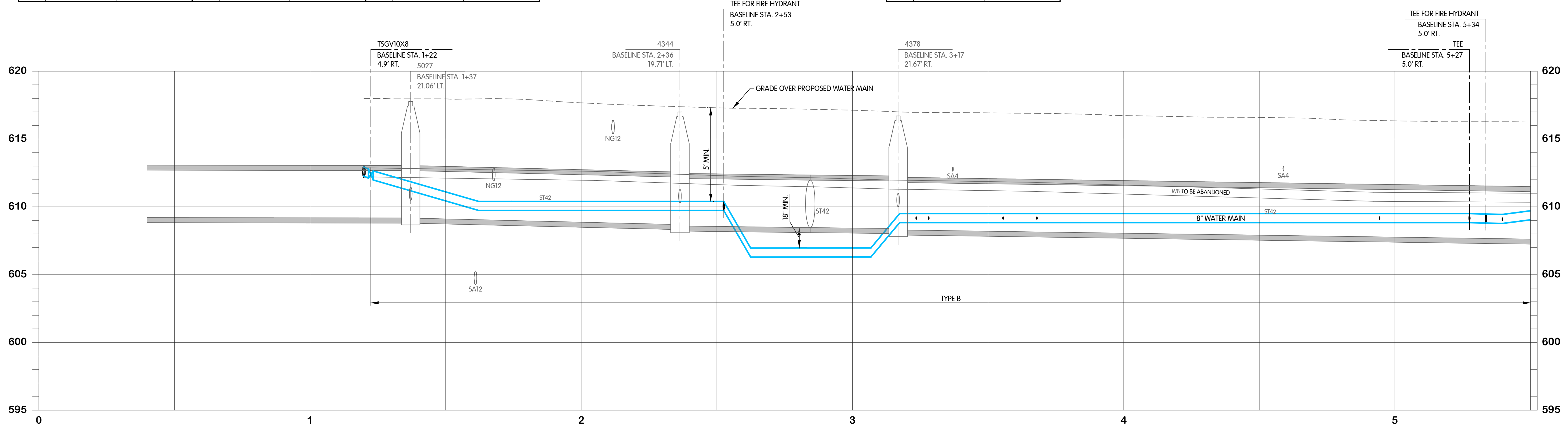

TOL-8150001-COMBINED-41 W-3-1.1 OREGON STA. 0+00 TO 5+50
12/30/2024 8:46 AM - JHARRISON
12/30/2024 9:55 AM

REVISIONS AFTER ISSUED FOR BID

NO.	DATE	DESCRIPTION
1	12/30/24	ADDENDUM 5

Jones & Henry
Engineers, Ltd.

Fluid thinking®
www.JHeng.com

JOB NO. 796-8149.001
SCALE 1"=20' HOR.
1"=4' VERT.
THIS LINE SCALES IF WHEN PLOTTED TO NOTED SCALE

DESIGNED	DRAWN	CHECKED
EAJ	DJK	TAB

STATUS: ISSUED FOR BID
DATE: NOVEMBER 2024

SHEET NO.
W-3-1.1
41 of 116